

PREMIUM

- EST. 1956 -

 LIPPERT®

AXLE PARTS

**INTENTIONALLY LEFT BLANK
FOR TWO-PAGE VIEWING**



TRAILER AXLES FAST AND EASY

EASY ONLINE
ORDERING

ASSEMBLED
IN THE USA

FREE & FAST
SHIPPING*

**QUALITY AXLES,
QUICK DELIVERY.**

**TRUST THE BRAND THAT MANUFACTURES OVER
3,000 SPRING & TORSION AXLES EVERY DAY.**



LIMITED 1-YEAR warranty on grease and oil seals for all axles

LIMITED 6-YEAR warranty on spring axle welds and suspension systems

LIMITED 11-YEAR warranty on torsion axle welds and suspension components



PLACE YOUR AXLE
ORDER TODAY!

*Most common utility trailer axles ship same or next business day (24-hour axle program).
Custom axles and stocking orders of four or more axles may have a longer lead time.

Connect with us      

TRAILER AXLE SOLUTIONS

Since 2005, we've been a leading axle supplier to the utility trailer parts and recreational vehicle industries. Our trailer axles are engineered and constructed with cutting-edge technology, making them among the best in terms of quality and durability.

Our state-of-the-art robotic welders ensure the highest precision on every component you buy, leaving you with peace of mind on the road ahead. Plus, we make our replacement cargo axle assemblies and components traceable, giving us optimum product visibility and serviceability for your convenience.



Benefits of Lippert Axles



Robotic Welding

We utilize robotic welding for consistent, fully penetrated welds every time.

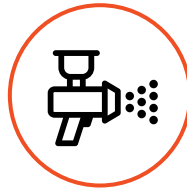

Durable Finish

Our powder-coated axle tube finish prevents premature corrosion from road salt and other chemicals.



Exceptional Quality

Our axles are QAI-certified to CSA Standard CAN3-D313-M85 for exceptional quality.

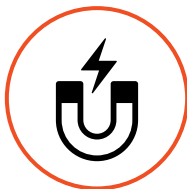

Magnet-Amp Checked

Each axle is magnet-amp checked for proper function in all wiring.



Aluminum Alloy Valcrum Caps

Aluminum alloy, upgraded Valcrum premium oil bath caps will not crack like plastic oil caps.

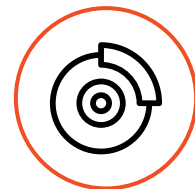

Multiple Brake Options

We offer standard electric, forward self-adjusting and hydraulic brakes for your replacement axle.

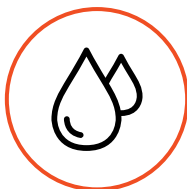

Waterproof Electrical Wiring Connections

Protected connections help prevent corrosion and ensure long-term performance.



Super Lube Lubrication System

This system saves time, requiring no disassembly and filling the entire bearing cavity with grease, allowing for complete submersion. This system offers better long-term protection over standard hubs.



TORSION AXLES

- Requires less maintenance than spring axles
- Rubberized torsion beam and cords absorb road shock and vibrations for a quiet, smooth ride
- Available in square and diamond orientations
- Various starting angles control trailer height
- Independent wheel suspension



Diamond pattern torsion axle

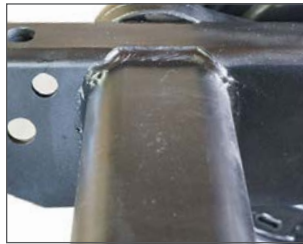

Square pattern torsion axle



SPRING AXLES

- Integrated, one-piece spindle flange
- Straight or drop spindles
- Slipper or double-eye leaf spring suspension
- Standard or upgraded equalizer suspension



Feature	Torsion Axles	Spring Axles
Warranty	11-year	6-year
Axle configuration	Single, tandem	Single, tandem, triple
Axle capacity	2K - 7K (diamond) / 2K - 12K (square)	2K - 16K
Idler axles	2K - 8K	2K - 8K
CSA certification	2K - 8K	2K - 8K
Valcrum premium oil caps (included)	8K - 12K	8K - 16K
Oil bath (option)	7K - 12K	7K - 16K
Forward self-adjusting brakes (option)	3.5K - 12K	3.5K - 16K
Hutch HD suspension system (option)	--	10K - 16K
Super Lube lubrication system (option)	2K - 8K	2K - 8K

BUILD YOUR OWN AXLE

In crafting our axle assemblies, we assign part numbers that delineate the characteristics of each component. These numbers correspond to the axle capacity, beam type, hub face dimension, spring center dimension, tie plate type, spring mounting type, lubrication type, bolt pattern, leaf spring type, and pigtail type. The foundational structure of our part numbering system is outlined below.

Example Axle Number

LCI60-SB-86.5-68.5-NOSP-OS-L-65517-7226-30PT

Example Axle Number Breakdown & Definitions									
Model	Spindle and Brake	Hub Face Dimension	Spring Center Dimension	Tie Plate	Spring Mounting	Lubrication	Hub or Hub / Drum	Leaf Spring	Pigtail Type
LCI60	SB	86.5	68.5	NOSP	OS	L	65517	7226	30PT

Axle Number Breakdown, Definitions & Options

Model	
Code	Description
LCI20	2,000 lbs.
LCI35	3,500 lbs.
LCI44	4,400 lbs.
LCI52	5,200 lbs.
LCI60	6,000 lbs.
LCI70	7,000 lbs.
LCI80H (hybrid)	8,000 lbs.
LCI80	8,000 lbs.
LCI100S (short)	10,000 lbs.
LCI120	12,000 lbs.
LCI160	16,000 lbs.

Spindle and Brake	
Code	Description
Spindles	
S	Straight spindle
D	4" drop spindle
Brakes	
B	Electric drum brake
BSA	Electric drum brake, self-adjust
I	Idler hub, no brake
HUSFB	Hydraulic uni-servo drum brake, free backing
AB	Air brake
D	Hydraulic disc brake

Hub Face Dimension
Distance between wheel mounting surfaces of hubs

Spring Center Dimension	
Code	Description
NOSS	No spring seats welded
Distance between spring centers	

Tie Plate	
Code	Description
NOSP	Standard tie plate
FIXSS	Fixed spring seats, both sides (10K - 16K)
ADJSS	One fixed and one adjustable spring seat (10K - 16K)
HUTSS	HD suspension system spring seat, welded (10K - 16K)

Spring Mounting	
Code	Description
OS	Overslung, on top of axle tube
US	Underslung, underneath axle tube

Lubrication	
Code	Description
L	Super-lube
G	Standard grease
O	Oil lubrication

Hub or Hub / Drum	
Code	Bolt Pattern
440	4 on 4"
545	5 on 4-1/2"
5475	5 on 4-3/4"
550	5 on 5"
555	5 on 5-1/2"
655	6 on 5-1/2"
660	6 on 6"
86517	8 on 6-1/2", 1/2" studs
86537	8 on 6-1/2", 9/16" studs
86580-9/16	8 on 6-1/2", 9/16" stud, 8K
86580-5/8	8 on 6-1/2", 5/8" stud, 8K
865	8 on 6-1/2", 5/8" studs, 10K - 12K
8/275	8 on 275 mm, 16K

Leaf Spring
Industry number, see page 22

Pigtail Type	
Code	Description
18PT	18" pigtails
30PT	30" pigtails

AXLE PARTS RETAIL PROGRAM

Lippert is your ultimate one-stop shop for axle parts and components. Our comprehensive offering features premium replacement parts meticulously crafted to meet the highest standards of quality and reliability. Whether you need bearings, hubs, brakes, or any other vital component, we offer exceptional performance and durability. These parts are readily available through Lippert, CURT, or one of our many distribution partners across the country.

Receive an in-store marketing package with your first qualifying purchase of premium Lippert retail packaged parts!



Header Card (4' or 8')

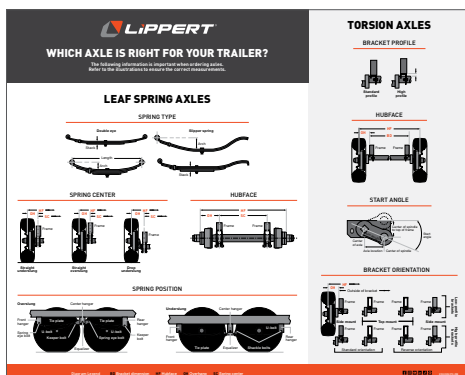

Counter Mat (20" x 16")



Metal Sign (29-1/2")

**GETTING YOU
BACK ON THE
ROAD AGAIN**



The display consists of several levels of shelving. The top level is a pegboard with 28 individual product packages hanging from it, including oil seals, grease seals, dust caps, and trailer bearing kits. Below the pegboard is a row of 12 red boxes, each labeled 'LIPPERT' and '10" BRAKE ASSEMBLY'. The next level down features three large white boxes for '10" PRE-ASSEMBLED HUB & DRUM' and two smaller red boxes for '10" BRAKE ASSEMBLY'. The following level has three large white boxes for '12" PRE-ASSEMBLED HUB & DRUM' and two smaller red boxes for '12" BRAKE ASSEMBLY'. The bottom level also features three large white boxes for '12" PRE-ASSEMBLED HUB & DRUM' and two smaller red boxes for '12" BRAKE ASSEMBLY'. Each box contains detailed product information, including part numbers, descriptions in English and Spanish, and images of the components.



296649

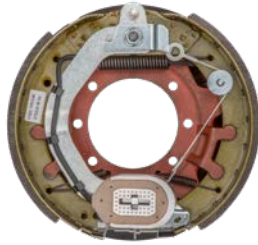

2024055288



2024120112



2024120113



2024120114

BRAKE ASSEMBLIES

For more information, see pages 6 and 33.

Retail Box #	Axle Capacity	Brake Size	Vehicle Side
Manual Adjusting			
297956	3,500 lbs.	10" x 2-1/4"	Driver
298274	3,500 lbs.	10" x 2-1/4"	Pass.
298275	5,200 - 8,000 lbs. hybrid	12" x 2"	Driver
298276	5,200 - 8,000 lbs. hybrid	12" x 2"	Pass.
Self Adjusting			
296649	3,500 lbs.	10" x 2-1/4"	Driver
296650	3,500 lbs.	10" x 2-1/4"	Pass.
296651	5,200 - 8,000 lbs. hybrid	12" x 2"	Driver
296652	5,200 - 8,000 lbs. hybrid	12" x 2"	Pass.
2024055286	8,000 lbs.	12-1/4" x 3-3/8"	Driver
2024055287	8,000 lbs.	12-1/4" x 3-3/8"	Pass.
2024055288	10,000 lbs.	12-1/4" x 3-3/8"	Driver
2024055289	10,000 lbs.	12-1/4" x 3-3/8"	Pass.
2024055290	12,000 - 16,000 lbs.	12-1/4" x 5"	Driver
2024055291	12,000 - 16,000 lbs.	12-1/4" x 5"	Pass.



2024013264

BRAKE HUB KITS

For more information, see page 36.

Retail Box #	Axle Capacity	Brake Hub Size	Bolt Pattern	Stud Size
2024013264	3,500 lbs.	10"	5 on 4-1/2"	1/2"
2024114172	3,500 lbs.	10"	5 on 5-1/2"	1/2"
2024013262	6,000 lbs.	12"	6 on 5-1/2"	1/2"
2024013260	7,000 lbs.	12"	8 on 6-1/2"	1/2"
2024013261	7,000 lbs.	12"	8 on 6-1/2"	9/16"

MAGNET KITS

For more information, see page 34.

Retail Clamshell #	Axle Capacity	Fits Brake Size
2024120112	3,500 lbs.	10" x 2-1/4"
2024120113	5,200 - 7,000 lbs.	12" x 2"
2024120114	8,000 - 16,000 lbs.	12-1/4"



2024120111

ADJ. SCREW & SPRING KIT

For more information, see page 35.

Retail Clamshell #	Fits Brake Size	Brake Adjustment
2024120111	10" and 12"	Manual



2024013263

IDLER HUB KITS

For more information, see page 39.

Retail Box #	Axle Capacity	Bolt Pattern	Stud Size
2025013495	2,200 lbs.	4 on 4"	1/2"
2025013496	2,200 lbs.	5 on 4-1/2" w/ 5-1/2" flange	1/2"
2025013497	2,200 lbs.	5 on 4-1/2" w/ 6-1/2" flange	1/2"
2024013263	3,500 lbs.	5 on 4-1/2"	1/2"
2024044866	3,500 lbs.	5 on 5"	1/2"
2025013498	4,400 lbs.	6 on 5-1/2"	1/2"



2023133979



2023134018

2023134654

BEARING KITS

For more information, see page 44.

Retail #	Axle Capacity
Clamshell	
2023133979	2,000 lbs.
2023133980	3,500 lbs.
2023133981	5,200 lbs.
2023133982	6,000 lbs.
2023133983	7,000 lbs.
Retail Box	
2023133984	8,000 lbs.
2023133985	10,000 lbs.
2023133986	12,000 - 16,000 lbs.

GREASE & OIL SEALS

For more information, see page 45.

Retail Clamshell #	Axle Capacity	Spindle Shaft Diameter
Grease Seals		
2023134653	2,200 lbs.	1.5"
2023134654	3,500 lbs.	1.719"
2023134655	5,200 - 8,000 lbs.	2.25"
Oil Seals		
2023134018	5,200 - 8,000 lbs.	2.250"
2023134019	10,000 lbs.	2.875"
2023134020	12,000 - 16,000 lbs.	3.125"



2023134021



2023134658

2023134661

2023134012

SPINDLE NUT KITS

For more information, see page 46.

Retail Clamshell #	Axle Capacity	Washers Included
2023134656	2,000 - 8,000 lbs.	1" round
2023134657	2,000 - 8,000 lbs.	1" D-flat / 1" locking tang
2023134021	10,000 lbs.	1-1/2" round
2023134022	12,000 - 16,000 lbs.	1-7/8" round

STANDARD DUST CAPS

For more information, see page 49.

Non Lubed Clamshell #	Lubed Clamshell #	Axle Capacity	Bore Size
Dust Caps			
2023134658	2023134661	2,000 - 3,500 lbs.	2"
2023134659	2023134662	5,200 - 6,000 lbs.	2-1/2"
2023134660	2023134011	7,000 - 8,000 lbs.	2-3/4"
Dust Cap Rubber Plug			
2023134012	For use with standard lubed dust caps		



2023134013



2024039634

WHEEL STUDS

For more information, see page 40.

Retail Clamshell #	Qty	Diameter	Shoulder Length	Thread Size
2023134013	6	0.617" knurl	2"	1/2"-20
2025047362	6	0.545" knurl	2"	1/2"-20
2023134014	4	0.617" knurl	2-5/16"	9/16"-18
2024055282	4	0.689" knurl	2-5/16"	9/16"-18
2024055283	4	0.689" knurl	2-3/4"	5/8"-18
2024055284	4	0.689" knurl	3-7/16"	5/8"-18
2024055285	4	1.007" knurl	4-13/16"	M22 x 1.5

LUG NUTS

For more information, see page 40.

Retail Clamshell #	Qty	Type	Thread Size
2024039632	6	60° cone wheel	1/2"-20
2024039633	8	60° cone wheel	9/16"-18
2024039634	8	Hex flange	5/8"-18
2024039635	8	Swiveling flange	5/8"-18
2025047365	8	Swiveling flange	M22-1.5



2024114953



2024115689

EQUA-FLEX® EQUALIZER

For more information, see page 55.

Retail Box #	Axle Capacity	Axle Configuration
2024114953	4,000 - 6,000 lbs.	Tandem
2024115051	5,000 - 8,000 lbs.	Tandem
2024115101	5,000 - 8,000 lbs.	Triple, short
2024115382	5,000 - 8,000 lbs.	Triple, long

ROAD ARMOR™ EQUALIZER

For more information, see page 54.

Retail Box #	Axle Capacity	Axle Configuration
2024115689	3,500 - 8,000 lbs.	Tandem
2024115697	3,500 - 8,000 lbs.	Triple, short
2024115710	3,500 - 8,000 lbs.	Triple, long

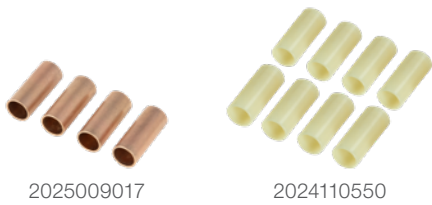

BUSHINGS

For more information, see page 53.

Retail Clam #	Qty	Material	Inside Diam.	Length
2025009017	4	Bronze	9/16"	1-3/4"
2025009018	8	Bronze	9/16"	1-3/4"
2024110549	4	Nylon	9/16"	1-3/4"
2024110550	8	Nylon	9/16"	1-3/4"



SHACKLE LINKS

For more information, see page 63.

Retail Clamshell 4-Pack #	Shackle Thickness	Center-to-Center
2024120104	0.224"	2-1/4"
2024120105	0.224"	3-1/8"
2024120108	1/2"	2-1/4"
2024120109	1/2"	3-1/8"



2024118832

U-BOLT MOUNTING KITS

For more information, see page 66.

Retail Box #	Axle Capacity	Length	Slipper Spring Width	Double-Eye Spring Width
2024118832	8,000 lbs.	7-1/4"	2"	1-3/4"



2024120106

2024120107

SUSPENSION BOLT & NUT KITS

For more information, see page 64.

Retail Clamshell 4-Pack #	Type	Diameter	Shoulder Length
2024120106	Shoulder bolt	9/16"	2-5/16"
2025047366	Shoulder bolt	9/16"	2-13/16"
2024120107	Wet bolt	9/16"	2-5/16"
2024120110	Wet bolt	9/16"	2-13/16"

U-BOLT & NUT KITS

For more information, see page 66.

Retail #	Axle Capacity	Fits Axle Tube Size	Length
Clamshell			
2024117444	2,200 lbs.	1-3/4"	4-3/8"
2024117446	3,500 lbs.	2-3/8"	5-1/8"
2024117447	4,400 lbs.	3"	6-1/2"
Retail Box			
2024117449	8,000 lbs.	3"	7-1/4"
2024117450	10,000 lbs.	4"	8-3/4"
2024117451	10,000 - 16,000 lbs.	5"	10"



2024117444

2024117451



WHEEL END PARTS BY CAPACITY

PRODUCT INDEX

Scan QR code for most up-to-date products or visit lippert.com



2.2K

13
2,200-lb.
Wheel End
Options

3.5K

14
3,500-lb.
Wheel End
Options

3.5K

15
3,500-lb.
Wheel End
5 on 4-1/2"

5.2K

16
5,200-lb.
Wheel End
6 on 5-1/2"

6K

17
6,000-lb.
Wheel End
6 on 5-1/2"

7K

18
7,000-lb.
Wheel End
8 on 6-1/2"

8K

19
8,000-lb. Hybrid
Wheel End
8 on 6-1/2"

8K

20
8,000-lb.
Wheel End
8 on 6-1/2"

10K

21
10,000-lb. Short
Wheel End
8 on 6-1/2"

12K

22
12,000-lb.
Wheel End
8 on 6-1/2"

16K

23
16,000-lb.
Wheel End
8 on 275mm

3.5K

24
3,500-4,400-lb.
Disc Brake End

4.4K

6K

5.2K

25
5,200-6,000-lb.
Disc Brake End

8K

7K

26
7,000-8,000-lb.
Hybrid
Disc Brake End

8K

27
8,000-lb.
Disc Brake End

10K

28
10,000-lb.
Disc Brake End

12K

28
12,000-lb.
Disc Brake End

16K

29
16,000-lb.
Disc Brake End

HOW TO MEASURE BOLT PATTERNS

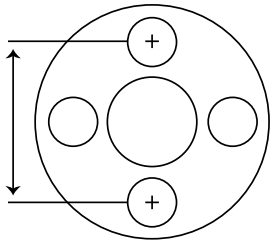

4-lug

From the middle point of two holes located directly across from each other.

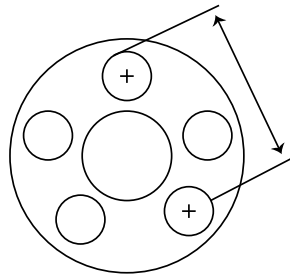

5-lug

From the middle point of one hole to back end of the hole across from it.

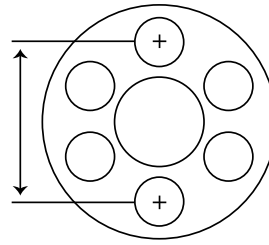

6-lug

From the middle point of two holes located directly across from each other.

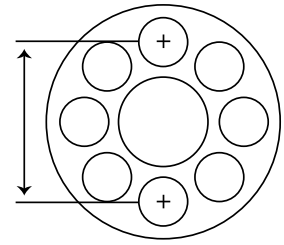

8-lug

From the middle point of two holes located directly across from each other.

SHORT AXLES

The short axle is a specialized type of axle designed for trailers that need to handle tight spaces or reduced overhangs. The 10K short axle is one of the most popular versions of this design. It's capable of handling up to 10,000 lbs. of weight and can be used in both single and dual-tire configurations.

One of the standout features of the short axle is its ability to reduce unsprung mass and provide a tighter turning radius, making it ideal for applications where space is limited or where the trailer needs to stay closer to the ground. The 10K short axle can be used for heavy loads and is suitable for both single-axle and multi-axle setups.

If you need a high-quality, durable axle that is lightweight but strong, the short axle is an excellent choice, especially for trailers with specific size constraints.



Scan to explore different types of trailer axles

HYBRID AXLES

A hybrid spring axle combines elements of both traditional spring axles and modern design innovations. This type of axle aims to provide the best of both worlds: the rugged load-handling capacity of spring axles with improvements that reduce unsprung mass (the weight that isn't supported by the suspension) and increase the overall efficiency of the system. For example, a hybrid axle can allow for a lower profile and more clearance.

The 8K hybrid axle, exclusive to Lippert, is a popular example of this type of axle. It's rated for an 8,000-lb. capacity, but the drum brakes are rated for slightly less, at 7,000 lbs. This axle is perfect for applications requiring strength but with a lighter, more efficient design. Its ability to support heavier loads while reducing the unsprung mass makes it ideal for trailers that need to maneuver tighter turns and reduce wear on the tires.

The hybrid spring axle can be used in a wide range of applications, including boat trailers, car haulers, and other utility trailers. Its unique design offers an excellent balance between durability and performance.

2.2K 2,200 LB. IDLER WHEEL END OPTIONS

For additional options, see pages 30 - 49

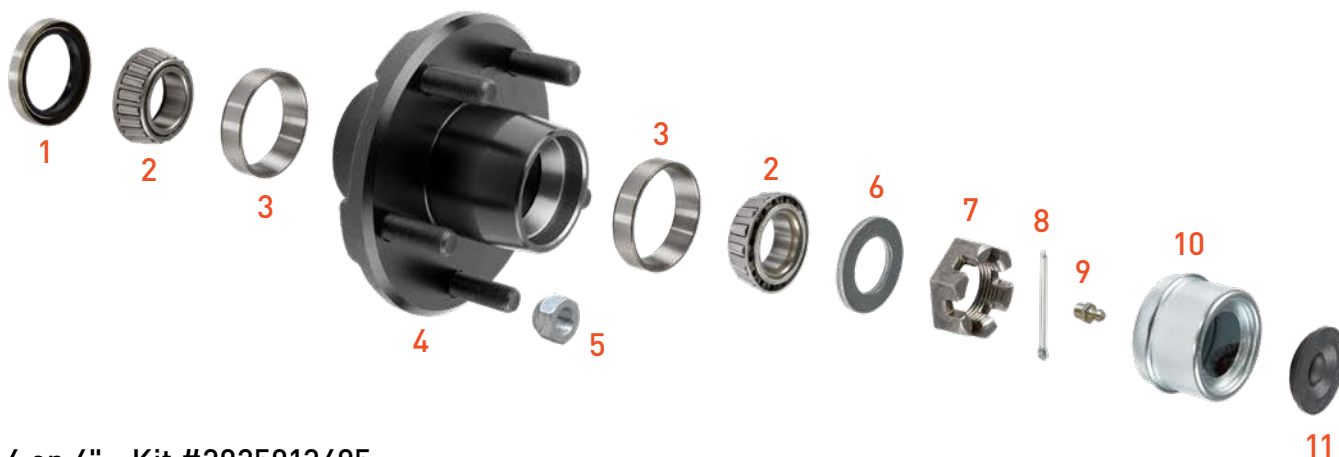

4 on 4" - Kit #2025013495

Part #	Item #	Description	Qty
2023133979	1	Grease seal (1.50" ID)	1
	2	Inner / outer bearing cone (L44649)	2
	3	Inner / outer bearing cup (L44610)	2
2024029106	No pic	Idler with 1/2" studs	1
2024039632	5	60° cone wheel nut (1/2"-20)	6

Part #	Item #	Description	Qty
2023134656	6	Spindle washer, round	1
	7	Six-slot spindle nut (1"-14)	1
	8	Cotter pin	1
2025027802	9	Grease zerk, lubed	10
2023134661	10	Lubed dust cap	2
	11	Dust cap rubber plug	2

5 on 4-1/2" with 5-1/2" flange - Kit #2025013496

Part #	Item #	Description	Qty
2023133979	1	Grease seal (1.50" ID)	1
	2	Inner / outer bearing cone (L44649)	2
	3	Inner / outer bearing cup (L44610)	2
2024029105	4	Idler with 1/2" studs (5-1/2" flange)	1
2024039632	5	60° cone wheel nut (1/2"-20)	6

Part #	Item #	Description	Qty
2023134656	6	Spindle washer, round	1
	7	Six-slot spindle nut (1"-14)	1
	8	Cotter pin	1
2025027802	9	Grease zerk, lubed	10
2023134661	10	Lubed dust cap	2
	11	Dust cap rubber plug	2

5 on 4-1/2" with 6-1/2" flange - Kit #2025013497

Part #	Item #	Description	Qty
2023133979	1	Grease seal (1.50" ID)	1
	2	Inner / outer bearing cone (L44649)	2
	3	Inner / outer bearing cup (L44610)	2
2024029111	No pic	Idler with 1/2" studs (6-1/2" flange)	1
2024039632	5	60° cone wheel nut (1/2"-20)	6

Part #	Item #	Description	Qty
2023134656	6	Spindle washer, round	1
	7	Six-slot spindle nut (1"-14)	1
	8	Cotter pin	1
2025027802	9	Grease zerk, lubed	10
2023134661	10	Lubed dust cap	2
	11	Dust cap rubber plug	2

3.5K 3,500 LB. IDLER WHEEL END OPTIONS

For additional options, see pages 30 - 49

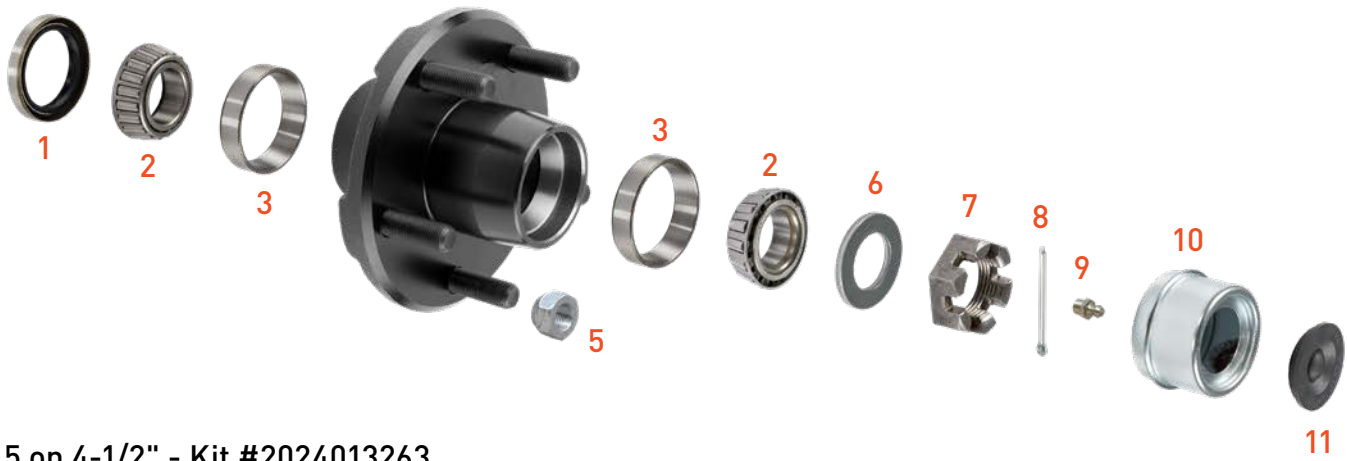

5 on 4-1/2" - Kit #2024013263

Part #	Item #	Description	Qty
2023133980	1	Grease seal (1.50" ID)	1
	2	Inner (L68149) / outer (L44649) bearing cone	2
	3	Inner (L68111) / outer (L44610) bearing cup	2
2024029104	No pic	Idler with 1/2" studs	1
2024039632	5	60° cone wheel nut (1/2"-20)	6

Part #	Item #	Description	Qty
2023134656	6	Spindle washer, round	1
	7	Six-slot spindle nut (1"-14)	1
	8	Cotter pin	1
2025027802	9	Grease zerk, lubed	10
2023134661	10	Lubed dust cap	2
	11	Dust cap rubber plug	2

5 on 5" - Kit #2024044866

Part #	Item #	Description	Qty
2023133980	1	Grease seal (1.719" ID)	1
	2	Inner (L68149) / outer (L44649) bearing cone	2
	3	Inner (L68111) / outer (L44610) bearing cup	2
2024029109	No pic	Idler with 1/2" studs	1
2024039632	5	60° cone wheel nut (1/2"-20)	6

Part #	Item #	Description	Qty
2023134656	6	Spindle washer, round	1
	7	Six-slot spindle nut (1"-14)	1
	8	Cotter pin	1
2025027802	9	Grease zerk, lubed	10
2023134661	10	Lubed dust cap	2
	11	Dust cap rubber plug	2

3.5K 3,500 LB. WHEEL END 5 ON 4-1/2" PARTS

For additional options,
see pages 30 - 49



Kit #2024013264
(excluding brakes)

Standard wheel end parts

Part #	Item #	Description	Qty
298274	1	Brake, right (10" x 2-1/4")	1
297956	1.1	Brake, left (10" x 2-1/4")	1
2023133980	2	Grease seal (1.72" ID)	1
	3	Inner bearing cone (L68149)	1
	4	Inner bearing cup (L68111)	1
	7	Outer bearing cup (L44610)	1
	8	Outer bearing cone (L44649)	1
2024029077	5	Hub drum with studs	1

Part #	Item #	Description	Qty
2024039632	6	60° cone wheel nut (1/2"-20)	6
2023134656	9	Spindle washer, round	1
	10	Six-slot spindle nut (1"-14)	1
	11	Cotter pin	1
2025027802	12	Grease zerk, lubed	10
2023134661	13	Lubed dust cap	2
	14	Dust cap rubber plug	2

Brake parts



Part #	Description	Qty
136451	Shoe and lining kit (10" x 2-1/4")	1
2024120112	Magnet kit (green wires)	1
2024120111	Adjuster screw and spring kit (manual)	1
2025027794	Hex bolt (7/16"-20)	10
2025027776	Hex lock nut (7/16"-20)	10

5.2K 5,200 LB. WHEEL END 6 ON 5-1/2" PARTS

For additional options,
see pages 30 - 49



Standard wheel end parts

Part #	Item #	Description	Qty
298276	1	Brake, right (12" x 2")	1
298275	1.1	Brake, left (12" x 2")	1
2023133981	2	Grease seal (2.25" ID)	1
	3	Inner bearing cone (25580)	1
	4	Inner bearing cup (25520)	1
	7	Outer bearing cup (LM67010)	1
	8	Outer bearing cone (LM67048)	1
	2024029080	5	Hub drum with studs

Part #	Item #	Description	Qty
2024039632	6	60° cone wheel nut (1/2"-20)	6
2023134656	9	Spindle washer, round	1
	10	Six-slot spindle nut (1"-14)	1
	11	Cotter pin	1
2025027802	12	Grease zerk, lubed	10
2023134662	13	Lubed dust cap	2
	14	Dust cap rubber plug	2

Brake parts



Part #	Description	Qty
136444	Shoe and lining kit (12" x 2")	1
2024120113	Magnet kit (black wires)	1
2024120111	Adjuster screw and spring kit (manual)	1
2025027775	Hex bolt (3/8"-24)	10
2025027773	Hex lock nut (3/8"-24)	10

6K**6,000 LB. WHEEL END
6 ON 5-1/2" PARTS**For additional options,
see pages 30 - 49Kit #2024013262
(excluding brakes)**Standard wheel end parts**

Part #	Item #	Description	Qty
298276	1	Brake, right (12" x 2")	1
298275	1.1	Brake, left (12" x 2")	1
2023133982	2	Grease seal, (2.25" ID)	1
	3	Inner bearing cone (25580)	1
	4	Inner bearing cup (25520)	1
	7	Outer bearing cup (15245)	1
	8	Outer bearing cone (15123)	1
2024029080	5	Hub drum with studs	1

Part #	Item #	Description	Qty
2024039632	6	60° cone wheel nut (1/2"-20)	6
2025027381	9	Spindle washer, round	1
	10	Six-slot spindle nut (1"-14)	1
	11	Cotter pin	1
2025027802	12	Grease zerker, lubed	10
2023134662	13	Lubed dust cap	2
	14	Dust cap rubber plug	2

Brake parts

136444



2024120113



2024120111



2025027773

Part #	Description	Qty
136444	Shoe and lining kit (12" x 2")	1
2024120113	Magnet kit (black wires)	1
2024120111	Adjuster screw and spring kit (manual)	1
2025027775	Hex bolt (3/8"-24)	10
2025027773	Hex lock nut (3/8"-24)	10

7K**7,000 LB. WHEEL END
8 ON 6-1/2" PARTS**For additional options,
see pages 30 - 49Kit #2024013260
(excluding brakes)**Standard wheel end parts**

Part #	Item #	Description	Qty
298276	1	Brake, right (12" x 2")	1
298275	1.1	Brake, left (12" x 2")	1
2023133983	2	Grease seal, (2.25" ID)	1
	3	Inner bearing cone (25580)	1
	4	Inner bearing cup (25520)	1
	7	Outer bearing cup (14276)	1
	8	Outer bearing cone (14125A)	1
2024029081	5	Hub drum with 1/2 studs	1
2024029082	No pic	Hub drum with 9/16 studs	1

Part #	Item #	Description	Qty
2024039632	6	60° cone wheel nut (1/2"-20)	6
2025027381	9	Spindle washer, round	1
	10	Six-slot spindle nut (1"-14)	1
	11	Cotter pin	1
2025027802	12	Grease zerk, lubed	10
2023134011	13	Lubed dust cap	2
	14	Dust cap rubber plug	2

Brake parts

Part #	Description	Qty
136444	Shoe and lining kit (12" x 2")	1
2024120113	Magnet kit (black wires)	1
2024120111	Adjuster screw and spring kit (manual)	1
2025027775	Hex bolt (3/8"-24)	10
2025027773	Hex lock nut (3/8"-24)	10

8K**8,000 LB. HYBRID WHEEL END
8 ON 6-1/2" PARTS**For additional options,
see pages 30 - 49**Standard wheel end parts**

Part #	Item #	Description	Qty
296652	1	Brake, right (12-1/4" x 3-3/8")	1
296651	1.1	Brake, left (12-1/4" x 3-3/8")	1
2023133984	2	Unitized oil seal (2.226" ID)	1
	3	Inner bearing cone (25580)	1
	4	Inner bearing cup (25520)	1
	7	Outer bearing cup (02420)	1
	8	Outer bearing cone (02475)	1

Part #	Item #	Description	Qty
2024029088	5	Hub drum with 5/8 studs	1
2024029091	No pic	Hub drum with 9/16 studs	1
2024039634	6	Flange wheel nut (5/8"-18)	8
2025027381	9	Spindle washer, round	1
	10	Six-slot spindle nut (1"-14)	1
	11	Cotter pin	1
2025027802	12	Grease zerk, lubed	10
85373928	13	Aluminum oil cap	1

Brake parts

136444



2024120113



2024120111



2025027773

Part #	Description	Qty
136444	Shoe and lining kit (12" x 2")	1
2024120113	Magnet kit (black wires)	1
2024120111	Adjuster screw and spring kit (manual)	1
2025027775	Hex bolt (3/8"-24)	10
2025027773	Hex lock nut (3/8"-24)	10

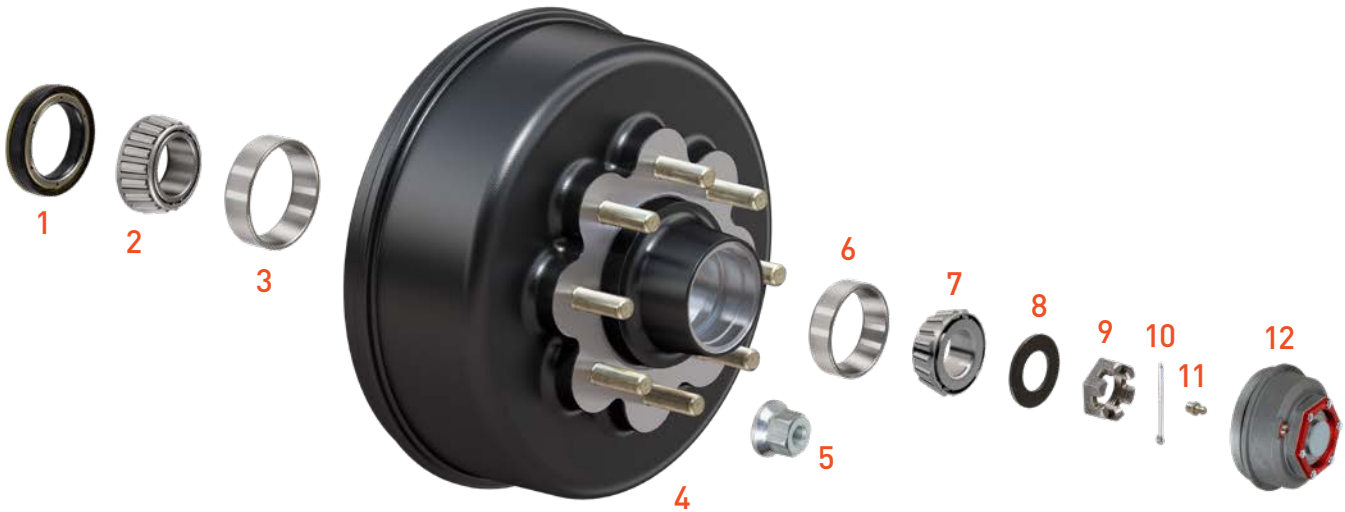
8K**8,000 LB. WHEEL END
8 ON 6-1/2" PARTS**For additional options,
see pages 30 - 49**Standard wheel end parts**

Part #	Item #	Description	Qty
2024055287	No pic	Brake, right (12-1/4" x 3-3/8")	1
2024055286	No pic	Brake, left (12-1/4" x 3-3/8")	1
2023133984	1	Unitized oil seal (2.226" ID)	1
	2	Inner bearing cone (25580)	1
	3	Inner bearing cup (25520)	1
	6	Outer bearing cup (02420)	1
	7	Outer bearing cone (02475)	1

Part #	Item #	Description	Qty
2024029085	4	Hub drum with 5/8 studs	1
2024029084	No pic	Hub drum with 9/16 studs	
2024039634	5	Flange wheel nut (5/8"-18)	8
2025027381	8	Spindle washer, round	1
	9	Six-slot spindle nut (1"-14)	1
	10	Cotter pin	1
2025027802	11	Grease zerk, lubed	10
85373928	12	Aluminum oil cap	1

Brake parts

Part #	Description	Qty
330792	Shoe and lining kit, left (12-1/4" x 3-3/8")	1
3307921	Shoe and lining kit, right (12-1/4" x 3-3/8")	1
2024120114	Magnet kit (yellow wires)	1
2025027730	Hex bolt (1/2"-20)	10
2025027753	Lock washer (1/2")	10
2025027786	Hex nut (1/2"-20)	10

10K**10,000 LB. SHORT WHEEL END
8 ON 6-1/2" PARTS**For additional options,
see pages 30 - 49**Standard wheel end parts**

Part #	Item #	Description	Qty
2024028241	No pic	Brake, right (12-1/4" x 3-3/8")	1
2024028240	No pic	Brake, left (12-1/4" x 3-3/8")	1
2023133985	1	Unitized oil seal (2.875" ID)	1
	2	Inner bearing cone (387A)	1
	3	Inner bearing cup (382A)	1
	6	Outer bearing cup (25520)	1
	7	Outer bearing cone (25580)	1

Part #	Item #	Description	Qty
2025027793	No pic	Hub drum mounting bolt	10
2025047373	No pic	Wheel clamp ring (5/8" stud)	2
2025013491	4	Brake drum	1
2024029119	4.1	Idler with 5/8" studs	1
2024039634	5	Flange wheel nut (5/8"-18)	8
2023134021	8	Spindle washer	1
	9	Spindle nut (1-1/2"-12)	1
	10	Cotter pin	1
85373829	11	Aluminum grease cap	1

Brake parts

Part #	Description	Qty
330792	Shoe and lining kit, left (12-1/4" x 3-3/8")	1
3307921	Shoe and lining kit, right (12-1/4" x 3-3/8")	1
2024120114	Magnet kit (yellow wires)	1
2025027794	Hex bolt - 7/16"-20	10
2025027752	Lock washer - 7/16"	10

12K**12,000 LB. WHEEL END
8 ON 6-1/2" PARTS**For additional options,
see pages 30 - 49**Standard wheel end parts**

Part #	Item #	Description	Qty
2024028243	No pic	Brake, right (12-1/4" x 5")	1
2024028241	No pic	Brake, left (12-1/4" x 5")	1
2023133986	1	Unitized oil seal (3.125 ID)	1
	2	Inner bearing cone (3984)	1
	3	Inner bearing cup (3920)	1
	6	Outer bearing cup (28622)	1
	7	Outer bearing cone (28682)	1

Part #	Item #	Description	Qty
2025027793	No pic	Hub drum mounting bolt	10
2025047373	No pic	Wheel clamp ring (5/8" stud)	2
2025013492	4	Brake drum	1
2024029112	4.1	Idler with 5/8" studs	1
2024039634	5	Flange wheel nut (5/8"-18)	8
2023134022	8	Spindle washer (1-3/4")	1
	9	Spindle nut (1-3/4")	1
	10	Cotter pin	1
85373828	11	Aluminum oil cap	1

Brake parts

Part #	Description	Qty
330793	Shoe and lining kit, left (12-1/4" x 5")	1
3307931	Shoe and lining kit, right (12-1/4" x 5")	1
2024120114	Magnet kit (yellow wires)	1
2025027794	Hex bolt - 7/16"-20	10
2025027752	Lock washer - 7/16"	10

16K**16,000 LB. WHEEL END
8 ON 275MM PARTS**For additional options,
see pages 30 - 49**Standard wheel end parts**

Part #	Item #	Description	Qty
2024028243	No pic	Brake, right (12-1/4" x 5")	1
2024028241	No pic	Brake, left (12-1/4" x 5")	1
2023133986	1	Unitized oil seal (3.125 ID)	1
	2	Inner bearing cone (3984)	1
	3	Inner bearing cup (3920)	1
	6	Outer bearing cup (28622)	1
	7	Outer bearing cone (28682)	1

Part #	Item #	Description	Qty
2025027793	No pic	Hub drum mounting bolt	10
2025013492	4	Brake drum	1
2024029115	4.1	Idler with M22 studs	1
2025047365	5	Wheel nut, M22	8
2023134022	8	Spindle washer (1-3/4")	1
	9	Spindle nut (1-3/4")	1
	10	Cotter pin	1
85373828	11	Aluminum oil cap	1

Brake parts

Part #	Description	Qty
330793	Shoe and lining kit, left (12-1/4" x 5")	1
3307931	Shoe and lining kit, right (12-1/4" x 5")	1
2024120114	Magnet kit (yellow wires)	1
2025027794	Hex bolt - 7/16"-20	10
2025027752	Lock washer - 7/16"	10

3.5K & 4.4K 3,500 - 4,400 LB. DISC BRAKE END

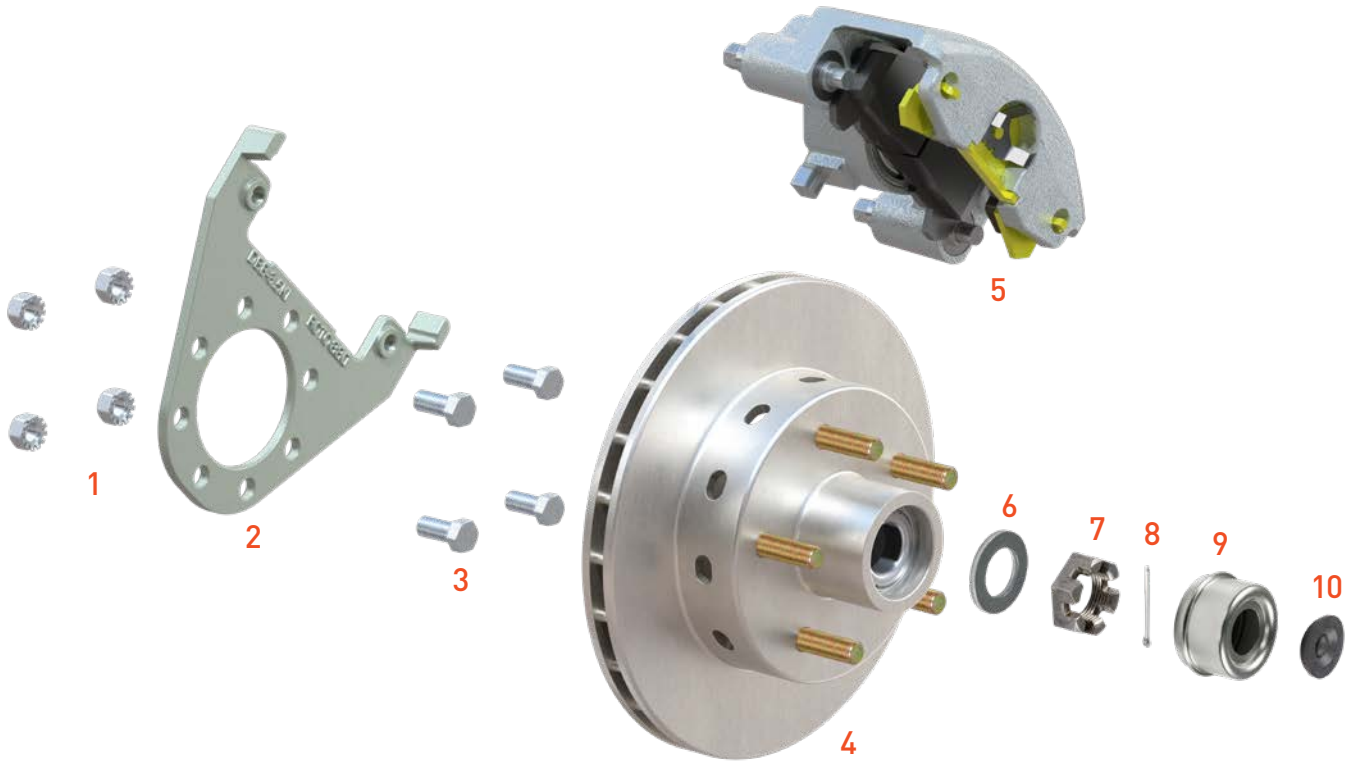

Standard disc brake end parts

Part #	Item #	Description	Qty
2025027776	1	Hex lock nut (7/16"-20)	10
2025013499	2	Caliper bracket	1
2025047367	3	Brake bolt (7/16"-20 x 1")	10
792638	4	Rotor assy (grease 1/2" stud)	1
2025013504	5	Caliper	1

Part #	Item #	Description	Qty
2023134656	6	Spindle washer, round	1
	7	Spindle nut (1")	1
	8	Cotter pin	1
2023134661	9	Dust cap	2
	10	Dust cap plug	2

5.2K & **6K** **5,200 - 6,000 LB.**
DISC BRAKE END

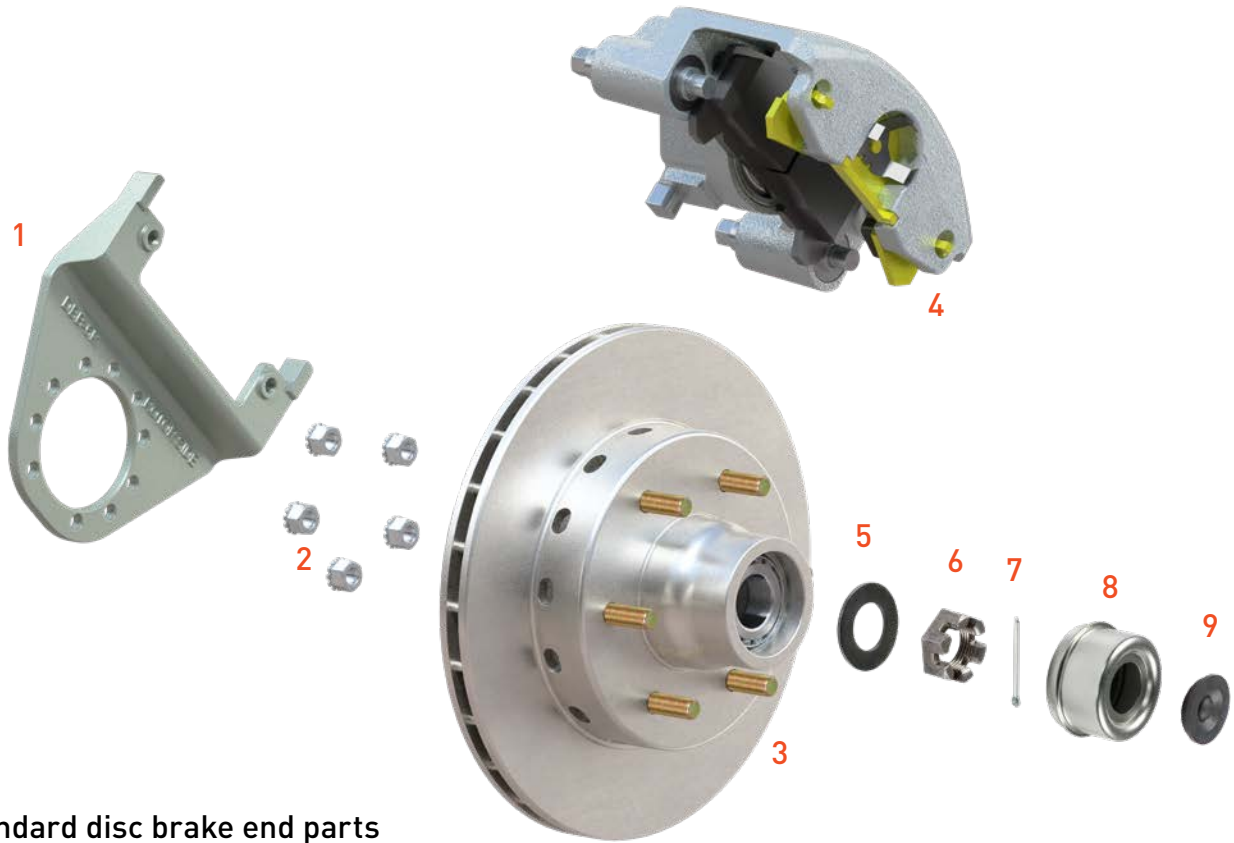

Standard disc brake end parts

Part #	Item #	Description	Qty
2025013500	1	Caliper bracket	1
2025027773	2	Hex nut (3/8"-24)	10
792640	3	Rotor assy (grease 1/2" stud)	1
2025013504	4	Caliper	1

Part #	Item #	Description	Qty
2025027381	5	Spindle washer, round	1
	6	Spindle nut (1")	1
	7	Cotter pin	1
2023134662	8	Dust cap	2
	9	Dust cap plug	2

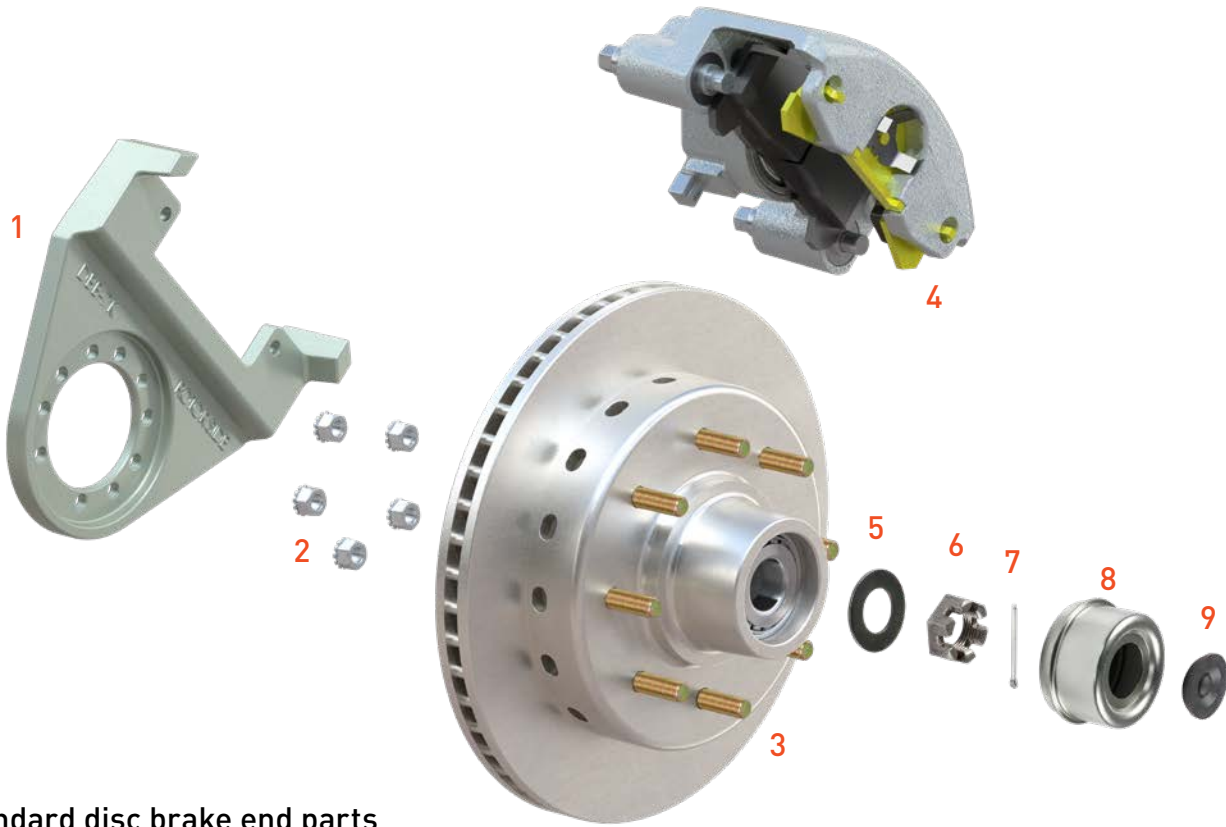
7K**&****8K****7,000 - 8,000 LB. HYBRID
DISC BRAKE END****Standard disc brake end parts**

Part #	Item #	Description	Qty
2025013501	1	Caliper bracket	1
2025027773	2	Brake mounting nut (3/8"-24)	10
792642	3	Rotor assy (grease 1/2" stud)	1
792676	No pic	Rotor assy (grease 9/16" stud)	1
792675	No pic	Rotor assy (oil 9/16" stud)	1
792679	No pic	Rotor assy (grease 5/8" stud)	1
792677	No pic	Rotor assy (oil 5/8" stud)	1
2025013505	4	Caliper	1

Part #	Item #	Description	Qty
2025027381	5	Spindle washer, round	1
	6	Spindle nut (1")	1
	7	Cotter pin	1
2023134011	8	Dust cap	1
	9	Dust cap plug	1
85373929	No pic	Threaded grease dust cap	1
85373928	No pic	Threaded oil dust cap	1

8K 8,000 LB. DISC BRAKE END

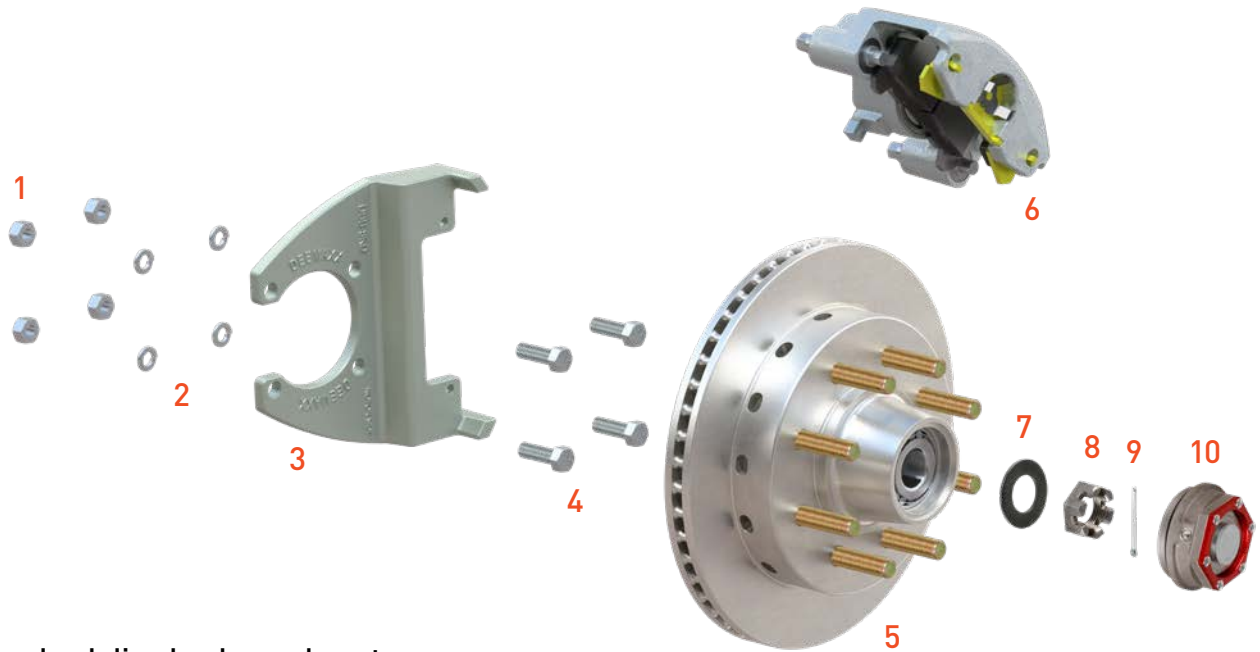

Standard disc brake end parts

Part #	Item #	Description	Qty
2025027730	1	Hex bolt (1/2"-20)	10
2025027753	2	Lock washer (1/2")	10
2025027786	3	Hex nut (1/2"-20)	10
2025013502	4	Caliper bracket	1
792676	No pic	Rotor assy (grease 9/16" stud)	1
792675	5	Rotor assy (oil 9/16" stud)	1
792679	No pic	Rotor assy (grease 5/8" stud)	1
792677	No pic	Rotor assy (oil 5/8" stud)	1

Part #	Item #	Description	Qty
2025013505	6	Caliper	1
2025027381	7	Spindle washer, round	1
	8	Spindle nut (1")	1
	9	Cotter pin	1
85373929	No pic	Threaded grease dust cap	1
85373928	10	Threaded oil dust cap	1

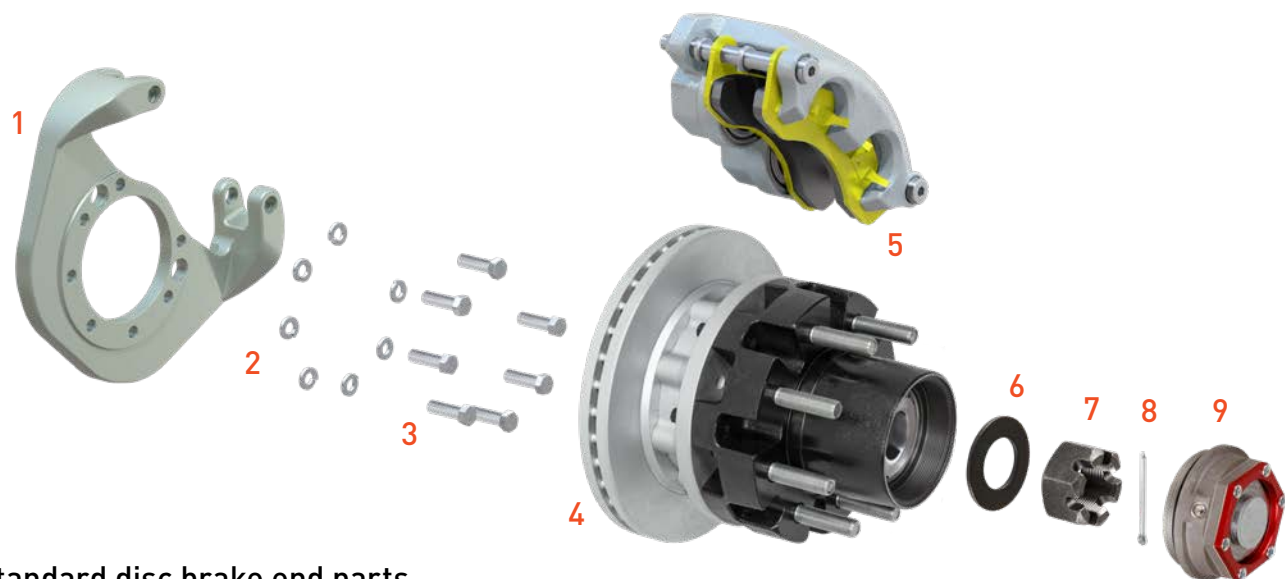
10K**10,000 LB.
DISC BRAKE END****Standard disc brake end parts**

Part #	Item #	Description	Qty
2025013503	1	Caliper bracket	1
2025027752	2	Lock washer (7/16")	10
2025027794	3	Hex bolt (7/16"-20)	10
2025048500	4	Rotor assy (oil 5/8" stud)	1
2025013506	5	Caliper	1

Part #	Item #	Description	Qty
2023134021	6	Spindle washer	1
	7	Spindle nut (1-1/2")	1
	8	Cotter pin	1
85373928	9	Threaded oil dust cap	1

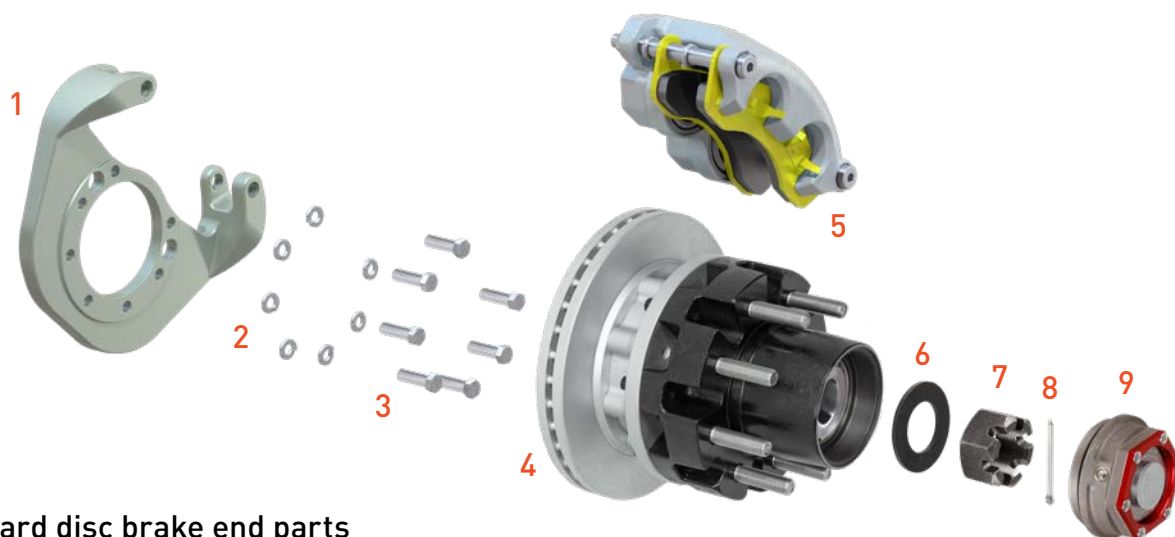
12K**12,000 LB.
DISC BRAKE END****Standard disc brake end parts**

Part #	Item #	Description	Qty
2025013503	1	Caliper bracket	1
2025027752	2	Lock washer (7/16")	10
2025027794	3	Hex bolt (7/16"-20)	10
2025048469	4	Rotor assy (oil 5/8" stud)	1
2025013506	5	Caliper	1

Part #	Item #	Description	Qty
2023134022	6	Spindle washer	1
	7	Spindle nut (1-3/4")	1
	8	Cotter pin	1
85373828	9	Threaded oil dust cap	1

16K **16,000 LB.**
DISC BRAKE END

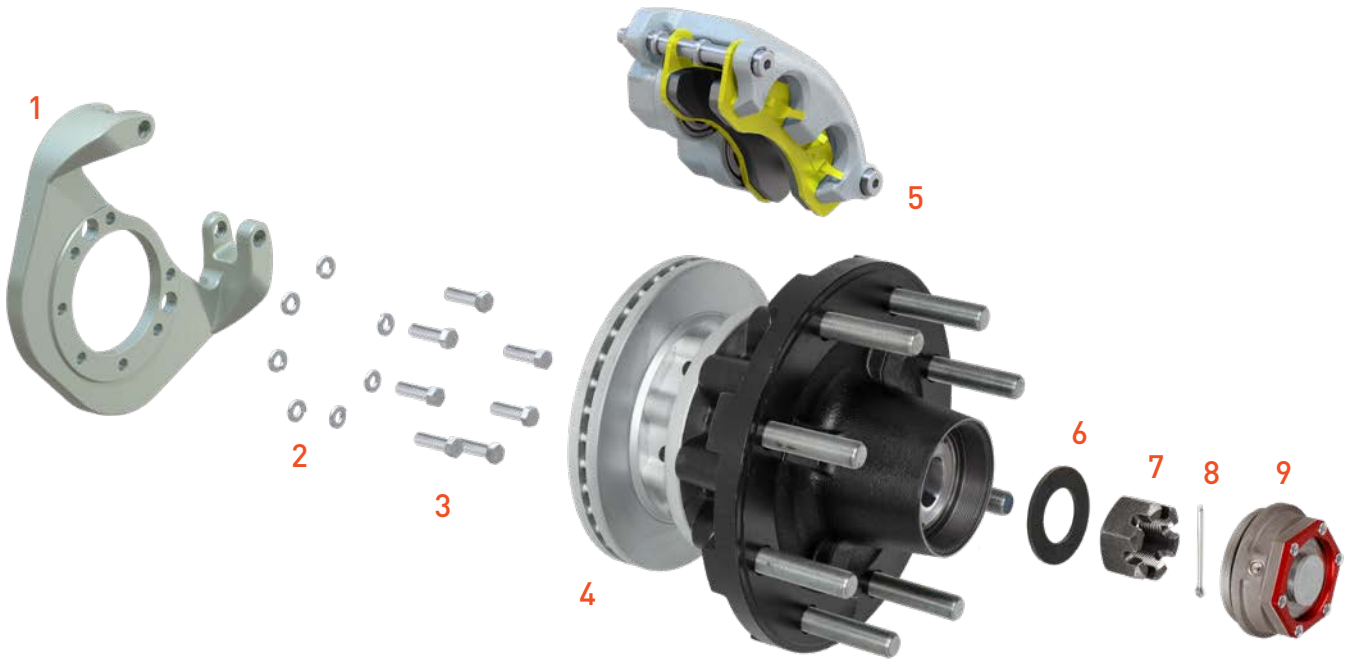

Standard disc brake end parts

Part #	Item #	Description	Qty
2025013503	1	Caliper bracket	1
2025027752	2	Lock washer (7/16")	10
2025027794	3	Hex bolt (7/16"-20)	10
2025048505	4	Rotor assy (oil 5/8" stud)	1
2025013506	5	Caliper	1

Part #	Item #	Description	Qty
2023134022	6	Spindle washer	1
	7	Spindle nut (1-3/4")	1
	8	Cotter pin	1
85373828	9	Threaded oil dust cap	1



WHEEL END PARTS BY TYPE

PRODUCT INDEX

Scan QR code for most up-to-date products or visit lippert.com

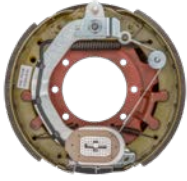

32
Electric Brake
Assemblies



34
Electric Brake
Repl. Parts



36
Brake Hubs
& Kits



38
Brake
Drums



39
Idler Hubs
& Kits



40
Wheel studs &
Lug Nuts



42
Disc Brake
Rotors



43
Disc Brake
Components



44
Bearing Kits &
Components



45
Grease &
Oil Seals



46
Spindle Nut
Components



48
Dust Caps &
Plugs

ELECTRIC BRAKE ASSEMBLIES

Universally compatible with Dexter

- Easy, DIY installation with pre-installed studs
- Linings fully bonded to shoes for longer life and excellent braking torque
- Durable magnets ensure consistent braking power
- Shoes feature automotive-grade friction material to ensure superior stopping performance and durability
- E-coat finish on backing plates resists rust and corrosion
- Requires only an electric brake controller (sold separately) — no actuator or hydraulic lines needed
- Brakes are compatible with all standard or aftermarket brake controllers
- Included adjuster plugs protect internal components from dirt, grime, and road debris
- Certified to QAI and CSA standards, ensuring exceptional quality and performance
- SAE-N certified for adherence to California and Washington state environmental regulations
- **Contact your sales representative for bulk pallet options**



389875

389876



297956

298274



2024028244

2024028245



298275

298276

Retail Box #	Brown Box #	Axle Capacity	Brake Size	Vehicle Side	Bolt Pattern
--	389875	2,200 lbs.	7" x 1-1/4"	Driver / left	Four-bolt
--	389876	2,200 lbs.	7" x 1-1/4"	Passenger / right	Four-bolt
297956	--	3,500 lbs.	10" x 2-1/4"	Driver / left	Four-bolt
298274	--	3,500 lbs.	10" x 2-1/4"	Passenger / right	Four-bolt
--	2024028244	4,400 lbs.	10" x 2-1/4"	Driver / left	Four-bolt
--	2024028245	4,400 lbs.	10" x 2-1/4"	Passenger / right	Four-bolt
298275	--	5,200 - 8,000 lbs. hybrid	12" x 2"	Driver / left	Five-bolt
298276	--	5,200 - 8,000 lbs. hybrid	12" x 2"	Passenger / right	Five-bolt

Retail box: includes mounting hardware

Brown box: mounting hardware sold separately

FORWARD SELF-ADJUSTING BRAKE ASSEMBLIES

Universally compatible with Dexter

- Brakes self-adjust during every forward stop, providing up to 50% shorter stopping distance
- Helps prevent premature brake lining and magnet wear for safer travel
- Self-adjustment feature ensures reliable contact between the brake shoes and drums
- Maintains brake-to-drum clearance for more consistent performance over brake's lifespan
- Easy, DIY installation with pre-installed studs
- Linings fully bonded to shoes for longer life and excellent braking torque
- Shoes feature automotive-grade friction material to ensure superior stopping performance and durability
- Requires only an electric brake controller (sold separately) — no actuator or hydraulic lines needed
- Brakes are compatible with all standard or aftermarket brake controllers
- Certified to QAI and CSA standards, ensuring exceptional quality and performance
- SAE-N certified for adherence to California and Washington state environmental regulations
- **Contact your sales representative for bulk pallet options**



296649

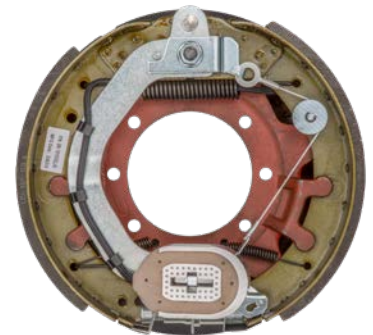
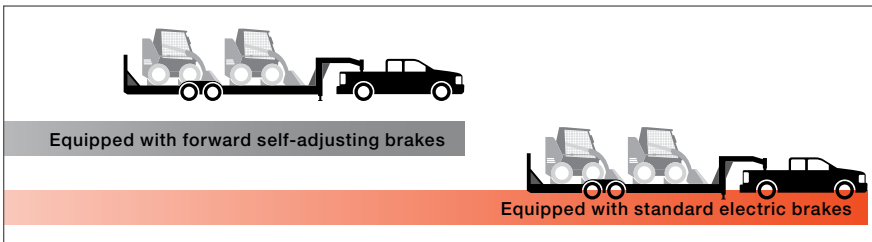

2024028240

Brakes self-adjust during every forward stop, so you can safely brake during emergency stops.

Retail Box #	Brown Box #	Axle Capacity	Brake Size	Vehicle Side	Bolt Pattern
296649	--	3,500 lbs.	10" x 2-1/4"	Driver / left	Four
296650	--	3,500 lbs.	10" x 2-1/4"	Passenger / right	Four
--	2024028246	4,400 lbs.	10" x 2-1/4"	Driver / left	Four
--	2024028247	4,400 lbs.	10" x 2-1/4"	Passenger / right	Four
296651	--	5,200 - 8,000 lbs. hybrid	12" x 2"	Driver / left	Five
296652	--	5,200 - 8,000 lbs. hybrid	12" x 2"	Passenger / right	Five
2024055286	298277	8,000 lbs.	12-1/4" x 3-3/8"	Driver / left	Four
2024055287	298279	8,000 lbs.	12-1/4" x 3-3/8"	Passenger / right	Four
2024055288	2024028240	10,000 lbs.	12-1/4" x 3-3/8"	Driver / left	Seven
2024055289	2024028241	10,000 lbs.	12-1/4" x 3-3/8"	Passenger / right	Seven
2024055290	2024028242	12,000 - 16,000 lbs.	12-1/4" x 5"	Driver / left	Seven
2024055291	2024028243	12,000 - 16,000 lbs.	12-1/4" x 5"	Passenger / right	Seven

Retail box: includes mounting hardware

Brown box: mounting hardware sold separately

ELECTRIC BRAKE REPLACEMENT COMPONENTS

Shoe and lining kits

- Replacement shoe and lining kit is compatible with Lippert electric brake assemblies
- Pads are fully bonded to shoes for long life and more braking torque
- Please consult your original equipment before purchasing
- Packaged in a durable brown box



Brown Box #	Axle Capacity	Vehicle Side	Adjustment	Brake Size
136451	3,500 lbs.	Universal	Manual	10" x 2-1/4"
136444	5,200 - 7,000 lbs.	Universal	Manual	12" x 2"
334312	3,500 lbs.	Driver / left	Self-adjusting	10" x 2-1/4"
334313	3,500 lbs.	Passenger / right	Self-adjusting	10" x 2-1/4"
334314	5,200 - 7,000 lbs.	Driver / left	Self-adjusting	12" x 2"
334316	5,200 - 7,000 lbs.	Passenger / right	Self-adjusting	12" x 2"
330792	8,000 - 10,000 lbs.	Driver / left	Self-adjusting	12-1/4" x 3-3/8"
3307921	8,000 - 10,000 lbs.	Passenger / right	Self-adjusting	12-1/4" x 3-3/8"
330793	12,000 - 16,000 lbs.	Driver / left	Self-adjusting	12-1/4" x 5"
3307931	12,000 - 16,000 lbs.	Passenger / right	Self-adjusting	12-1/4" x 5"

Magnet kits

- Oval design increases the efficiency while also extending the life of the magnet
- Compatible with Lippert electric brake assemblies
- Kits include magnet with lead wires, retainer clip, and spring
- Easy, DIY installation



Retail Clamshell #	Axle Capacity	Fits Brake Size	Lead Wire Color
2024120112	3,500 lbs.	10" x 2-1/4"	Green
2024120113	5,200 - 7,000 lbs.	12" x 2"	Black
2024120114	8,000 - 16,000 lbs.	12-1/4"	Yellow

ELECTRIC BRAKE REPLACEMENT COMPONENTS

Brake mounting bolts



10-Pack #	Axle Capacity	Knurl	Bolt Length	Thread Size	Fits Brake Size	Suggested Nut #	Suggested Washer #
2025027794	2,200 - 4,400 lbs.	--	13/16"	7/16"-20	7" x 1-1/4" 10" x 2-1/4"	2021136186	No washer
2025027775	4,400 - 8,000 lbs.	0.042"	5/16"	3/8"-24	12" x 2"	122077	No washer
2025027730	8,000 lbs.	--	1-1/2"	1/2"-20	12-1/4" x 3-3/8"	122253	162838
2025027794	10,000 - 16,000 lbs.	--	1-1/2"	7/16"-20	12-1/4" x 3-3/8" 12-1/4" x 5"	No nut	122086

Brake lock washers



2025027753

10-Pack #	Type	I.D.	O.D.
2025027752	Lock washer	7/16"	3/4"
2025027753	Lock washer	1/2"	7/8"

Adjuster screw and spring kit

- Includes one adjustment screw and spring for manual adjust brakes
- Designed for left (driver) and right-hand (passenger) brakes



2024120111

Retail Clamshell #	Fits Brake Size	Brake Adjustment
2024120111	10" and 12"	Manual

Brake mounting nuts



2025027772

2025027786

2025027786

10-Pack #	Type	Thread Size	Fits Brake Size
2025027772	Hex	7/16"-20	7" x 1-1/4" 10" x 2-1/4"
2025027776	Hex lock	7/16"-20	7" x 1-1/4" 10" x 2-1/4"
2025027786	Hex	1/2"-20	12-1/4" x 3-3/8" (8,000-lb. only)
2025027773	Hex lock	3/8"-24	12" x 2" 12-1/4" x 3-3/8" 12-1/4" x 5"

Wire connector

- Instantly splices two wires together using only pliers - no wire stripping
- Contains a sealant to protect against corrosion due to moisture
- Constructed from high-impact plastic to protect against corrosion
- Includes 10 blue or yellow connectors



2025027803

10-Pack #	Fits
2025027803	All electric brake lead wires 20-12 gauge wires



BRAKE HUB ASSEMBLIES & KITS

- Provides surface area for brake shoes to grip when brake is activated
- Compatible with electric or hydraulic drum brakes
- Accepts press-in dust caps
- Durable, cast-iron construction
- Multiple configurations available
- **Contact your sales representative for bulk pallet options**

Universally compatible with Dexter



2024029077



2024013264



814210

Axle Capacity	Brake Hub Size	Bolt Pattern	Wheel Size	Stud Size	Stud Length	Retail Kit Box #	Single Hub with Bearing Kit Not Installed #	Single Hub Only In Brown Box #
2,200 lbs.	7"	5 on 4-1/2"	10" - 13"	1/2"	1-1/4"	--	814209	2024029076
3,500 lbs.	10"	5 on 4-1/2"	12" - 15"	1/2"	1-1/4"	2024013264	814210	2024029077
3,500 lbs.	10"	5 on 5"	13" - 15"	1/2"	1-1/4"	2024114172	2025047521	2025019083
4,400 lbs.	10"	6 on 5-1/2"	14" - 15"	1/2"	1-1/4"	--	2025047522	2024029078
6,000 lbs.	12"	6 on 5-1/2"	15" - 16"	1/2"	1-1/4"	2024013262	814211	2024029080
7,000 lbs.	12"	8 on 6-1/2"	16"	1/2"	1-1/4"	2024013260	814212	2024029081
7,000 lbs.	12"	8 on 6-1/2"	16" - 17-1/2"	9/16"	1-1/2"	2024013261	814213	2024029082

Retail kit box: includes bearing kit (installed) and greased, lubed dust cap, cotter pin, castle nut, washer, lug nuts; in a full color retail box

Single hub with bearing kit (not installed): includes bearing kit (not installed); individually brown boxed

Single hub only in brown box: includes races and wheel studs; individually brown boxed

THREADED BRAKE HUB ASSEMBLIES

Universally compatible with Dexter

- Provides surface area for brake shoes to grip when brake is activated
- Compatible with electric or hydraulic drum brakes
- Races and corrosion-resistant, zinc-plated wheel studs come pre-installed
- Accepts Valcrum threaded dust caps for better sealing and damage prevention
- Durable, cast-iron construction
- Multiple configurations available
- **Contact your sales representative for bulk pallet options**



2024029092



2024029091



2024029088

Axle Capacity	Brake Hub Size	Bolt Pattern	Wheel Size	Stud Size	Stud Length	Single Oil Hub Assembly#	Single Hub Only In Brown Box #
Standard							
8,000 lbs.	12-1/4"	8 on 6-1/2"	16" - 17-1/2"	9/16"	1-5/16"	341279	2024029084
8,000 lbs.	12-1/4"	8 on 6-1/2"	17-1/2"	5/8"	1-3/4"	341280	2024029085
10,000 lbs.	12-1/4"	8 on 6-1/2"	16" - 17-1/2"	5/8"	2-1/4"	2025048471	2024029083
12,000 lbs.	12-1/4"	8 on 6-1/2"	16" - 17-1/2"	5/8"	2-3/16"	2025048467	2024029086
16,000 lbs.	12-1/4"	8 on 275 mm	17-1/2"	M22	3-5/16"	2025048503	2024029090
Short							
10,000 lbs.	12-1/4"	8 on 6-1/2"	16" - 17-1/2"	5/8"	2-1/4"	2025048502	2024029092
Hybrid							
8,000 lbs.	12"	8 on 6-1/2"	16" - 17-1/2"	9/16"	1.30"	380828	2024029091
8,000 lbs.	12"	8 on 6-1/2"	17-1/2"	5/8"	1-3/4"	347635	2024029088

Grease hub assembly: includes bearing kit, greased (installed)

Oil hub assembly: includes bearing kit (installed)

Single hub in pallet box: includes races and wheel studs

BRAKE DRUMS

- Compatible with electric or hydraulic drum brakes
- Durable, cast-iron construction
- See table below for matching idler hub
- **Contact your sales representative for bulk pallet options**

Universally compatible with Dexter

Axle Capacity	Brake Size	Brake Width	Raw Single Brown Box Drum #	Suggested Idler Hub #
10,000 lbs.	12-1/4"	3-3/8"	2025013490	2025047523
12,000 lbs.	12-1/4"	5"	2025013492	2024029112
16,000 lbs.	12-1/4"	5"	2025013492	2024029115
Short Design				
10,000 lbs.	12-1/4"	3-3/8"	2025013491	2024029119



Brake drum mounting bolt

- Compatible with 10,000 - 16,000-lb. axles
- Fits most two-piece brake drums
- Includes 10 mounting bolts



2025027793

10-Pack #	Axle Capacity	Length	Thread Size
2025027793	10,000 - 16,000-lb.	1-1/2"	1/2"-13

THREADED IDLER HUB ASSEMBLIES

- Does not allow for a trailer braking system
- Accepts Valcrum threaded dust caps for better sealing and damage prevention
- Durable, cast-iron construction
- Zinc-plated wheel studs resist corrosion
- Multiple configurations available
- **Contact your sales representative for bulk pallet options**

Universally compatible with Dexter



2024029119

Axle Capacity	Bolt Pattern	Wheel Size	Stud Size	Stud Length	Single Oil Hub Assy #	Single Hub Only In Brown Box #
8,000 lbs.	8 on 6-1/2"	16" - 17-1/2"	9/16"	1.30"	674748	2024029117
8,000 lbs.	8 on 6-1/2"	17-1/2"	5/8"	1.75"	717392	2024029118
10,000 lbs.	8 on 6-1/2"	16" - 17-1/2"	5/8"	2.26"	2025044135	2025047523
12,000 lbs.	8 on 6-1/2"	16" - 17-1/2"	5/8"	2.18"	2025043325	2024029112
16,000 lbs.	8 on 275 mm	17-1/2"	M22	3.31"	2025043327	2024029115
Short Design						
10,000 lbs.	8 on 6-1/2"	16" - 17-1/2"	5/8"	2.26"	2025043323	2024029119

Grease hub assembly: includes bearing kit, greased (installed)

Oil hub assembly: includes bearing kit (installed)

Single hub in brown box: includes races and wheel studs



IDLER HUB ASSEMBLIES & KITS

Universally compatible with Dexter

- Does not allow for a trailer braking system
- Accepts press-in dust caps
- Durable, cast-iron construction
- Zinc-plated wheel studs resist corrosion
- Multiple configurations available
- **Contact your sales representative for bulk pallet options**



2024029108



2024013263



141288

Axle Capacity	Bolt Pattern	Hub Flange Diameter	Wheel Size	Stud Size	Stud Length	Retail Kit Box #	Single Hub with Bearing Kit Not Installed #	Single Hub Only In Brown Box #
2,200 lbs.	4 on 4"	--	8" - 12"	1/2"	1-1/8"	2025013495	814206	2024029106
2,200 lbs.	5 on 4-1/2"	5-1/2"	8" - 12"	1/2"	1-1/8"	2025013496	814207	2024029105
2,200 lbs.	5 on 4-1/2"	6-1/2"	13" - 15"	1/2"	1-1/8"	2025013497	814205	2024029111
3,500 lbs.	5 on 4-1/2"	--	13" - 15"	1/2"	1-1/4"	2024013263	814208	2024029104
3,500 lbs.	5 on 5"	--	13" - 15"	1/2"	1-1/4"	2024044866	141287	2024029109
4,400 lbs.	6 on 5-1/2"	--	14" - 15"	1/2"	1-1/4"	2025013498	144604	2024029110
6,000 lbs.	6 on 5-1/2"	--	15" - 16"	1/2"	1-1/4"	--	141288	2024029108
7,000 lbs.	8 on 6-1/2"	--	16"	1/2"	1-1/4"	--	141291	2024029107
7,000 lbs.	8 on 6-1/2"	--	16"	9/16"	1-1/2"	--	427443	2024029116

Retail kit box: includes bearing kit (installed) and greased, lubed dust cap, cotter pin, castle nut, washer, lug nuts; in a full color retail box

Single hub with bearing kit (not installed): includes bearing kit (not installed); individually brown boxed

Single hub only in brown box: includes races and wheel studs; individually brown boxed

WHEEL STUDS



2023134013



2025047362



2023134014



2024055282



2024055283



2024055284



2024055285

Retail Clamshell #	Clamshell Quantity	10-Pack #	Diameter	Shoulder Length	Thread Size	Suggested Nut #
2023134013	6	2025027413	0.617" knurl	2"	1/2"-20	122076
2025047362	6	2025027416	0.545" knurl	2"	1/2"-20	122076
2023134014	4	2025027412	0.617" knurl	2-5/16"	9/16"-18	134581
2024055282	4	2025027414	0.689" knurl	2-5/16"	9/16"-18	134581
2024055283	4	2025027415	0.689" knurl	2-3/4"	5/8"-18	176321 or 723971
2024055284	4	2025027411	0.689" knurl	3-7/16"	5/8"-18	176321 or 723971
2024055285	4	2025027417	1.007" knurl	4-13/16"	M22-1.5	352303

LUG NUTS



2024039634



2024039632



2024039633



2024039635

Retail Clam #	Qty	10-Pack #	Type	Thread Size
2024039634	8	2025027782	Hex flange	5/8"-18
2024039632	6	2025027777	60° cone wheel	1/2"-20
2024039633	8	2025027778	60° cone wheel	9/16"-18
2024039635	8	2025027784	Swiveling flange	5/8"-18
2025047365	8	2025027785	Swiveling flange	M22-1.5



2025047365



DISC BRAKE ROTOR ASSEMBLIES

- Complete assembly from drum to disc brakes on one axle
- Upgrades the trailer's brakes from drum to disc for superior stopping power
- Provides smoother braking over drum brakes
- Vented design dissipates heat faster to prevent premature brake pad wear
- Durable cast-iron construction for strength and durability
- Zinc-plated finish offers superior corrosion resistance
- Hydraulic brake actuator required (sold separately)
- Includes one integral hub-rotor assembly with bearings, races, and grease seal
- One-piece hub-and-rotor assembly for easy, DIY installation (select models)
- **Contact your sales representative for bulk pallet options**



792676



2025048500



2025048469



2025048505

Axle Capacity	Bolt Pattern	Wheel Size	Stud Size	Single Grease Hub Assembly #	Single Oil Hub Assembly #
Standard - Press-In Dust Cap					
3,500 - 4,400 lbs.	5 on 4-1/2"	13" - 15"	1/2"	792638	--
6,000 lbs.	6 on 5-1/2"	15" - 16"	1/2"	792640	--
7,000 lbs.	8 on 6-1/2"	16"	1/2"	792642	--
Standard - Threaded Dust Cap					
8,000 lbs.	8 on 6-1/2"	16" - 17-1/2"	9/16"	792676	792675
8,000 lbs.	8 on 6-1/2"	17-1/2"	5/8"	792679	792677
10,000 lbs.	8 on 6-1/2"	16" - 17-1/2"	5/8"	--	2025048500
12,000 lbs.	8 on 6-1/2"	16" - 17-1/2"	5/8"	--	2025048469
16,000 lbs.	8 on 275 mm	17-1/2"	M22	--	2025048505

Single grease hub assembly #: includes inner bearing and seal, greased (installed)

Single oil hub assembly#: includes inner bearing and seal (installed)

DISC BRAKE CALIPERS

- Caliper holds and protects pistons for your hydraulic disc brake
- Custom caliper bodies designed for easy install
- Self-adjusting design ensures smooth, even braking
- Rigorous end-of-line inspection and pressure testing ensure quality and performance
- Durable, cast-iron construction prevents flexing to keep braking torque consistent
- Hydraulic brake actuator rated at 1,600 psi or above (sold separately) required to activate brakes
- Universal design works with driver and passenger side brakes
- Includes disc brake pads, fittings, and mounting bolts

Single Brown Box #	Axle Capacity	Hub Bolt Pattern
2025013504	3,500 - 6,000 lbs.	5 on 4-1/2" 6 on 5-1/2"
2025013505	7,000 - 8,000 lbs.	8 on 6-1/2"
2025013506	10,000 - 16,000 lbs.	8 on 6-1/2" 8 on 275 mm

DISC BRAKE CALIPER BRACKETS

- Zinc dichromate, anti-corrosion finishes provide rust resistance for iron caliper bodies and brackets
- Durable, cast-iron construction prevents flexing to keep braking torque consistent
- Universal design works with driver and passenger side brakes
- Easy, DIY installation
- Includes one caliper mounting bracket

Single Brown Box #	Axle Capacity	Bolt Pattern	Hub Bolt Pattern
2025013499	3,500 lbs.	Four-bolt	5 on 4-1/2"
2025013500	5,200 - 6,000 lbs.	Five-bolt	6 on 5-1/2"
2025013501	7,000 lbs.	Five-bolt	8 on 6-1/2"
2025013502	8,000 lbs.	Four-bolt	8 on 6-1/2"
2025013503	10,000 - 16,000 lbs.	Seven-bolt	8 on 6-1/2" 8 on 275 mm

DISC BRAKE PADS

- Brake pads apply pressure to your rotors to slow or stop your trailer's wheels
- Ceramic brake pads provide superior performance for more consistent braking
- Produce less dust than NAO or semi-metallic models
- Chamfered to prevent squeal
- Includes four brake pads
- Easy, DIY installation

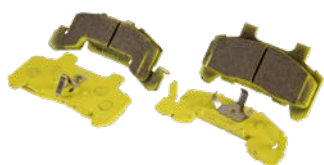

2021013448



2021013449



2021013450

Retail Box #	Brown Box #	Axle Capacity	Includes
2025013507	2021013448	3,500 - 6,000 lbs.	Four pads
2025013508	2021013449	7,000 - 8,000 lbs.	Four pads
2025013509	2021013450	10,000 - 16,000 lbs.	Four pads

BEARING KITS & COMPONENTS

Universally compatible with Dexter

- High-quality tapered roller bearings
- High-quality alloy blend reduces vibration
- Includes outer bearing with cotter pin, outer race, inner race, inner bearing, and grease seal



2023133982



2023133984



Retail Kit #	Poly Bag Kit #	Axle Capacity	Note: Industry number is for reference only. Do not use this number to order your parts				Seal #
			Outer Bearing Industry #	Outer Race Industry #	Inner Race Industry #	Inner Bearing Industry #	
2023133979	--	2,200 lbs.	L44649	L44610	L44610	L44649	139514
2023133980	333948	3,500 lbs.	L44649	L44610	L68111	L68149	122087
2023133981	333949	5,200 lbs.	LM67048	LM67010	25520	25580	122088
2023133982	333950	6,000 lbs.	15123	15245	25520	25580	122088
2023133983	333951	7,000 lbs.	14125A	14276	25520	25580	122088
2023133984	--	8,000 lbs.	02475	02420	25520	25580	122088
2023133985	--	10,000 lbs.	25580	25520	382A	387A	176692
2023133986	--	12,000 - 16,000 lbs.	28622	28682	3920	3984	295924

BEARINGS

- Easy, DIY installation
- Includes one bearing



Sleeve #	Sleeve Qty	Axle Capacity	Inner Diameter	Note: Industry number is for reference only. Do not use this number to order your parts		Race Industry #
				Lippert OE #	Industry #	
Outer						
2025027336	9	2,200 - 3,500 lbs.	1.0625"	122089	L44649	L44610
2025027365	8	5,200 lbs.	1.2500"	122090	LM67048	LM67010
2025027366	7	6,000 lbs.	1.2500"	122091	15123	15245
2025027341	8	7,000 lbs.	1.2500"	127009	14125A	14276
2025027344	5	8,000 lbs.	1.2500"	129752	02475	02420
2025027342	5	10,000 lbs.	1.7500"	122066	25580	25520
2025027361	5	12,000 - 16,000 lbs.	2.2500"	293382	28682	28622
Inner						
2025027336	9	2,200 lbs.	1.0625"	122089	L44649	L44610
2025027338	8	3,500 lbs.	1.3775"	122092	L68149	L68111
2025027342	5	5,200 - 8,000 lbs.	1.7500"	122066	25580	25520
2025027343	5	10,000 lbs.	2.2500"	183807	387A	382A
2025027360	4	12,000 - 16,000 lbs.	2.6250"	293380	3984	3920

RACES

- Easy, DIY installation
- Includes one race



Sleeve #	Sleeve Qty	Axle Capacity	Outer Diameter	Note: Industry number is for reference only. Do not use this number to order your parts		Bearing Industry #
				Lippert OE #	Industry #	
Outer						
2025027339	13	2,200 - 3,500 lbs.	1.9800"	125102	L44610	L44649
2025027362	15	5,200 lbs.	2.3280"	124292	LM67010	LM67048
2025027358	6	6,000 lbs.	2.4409"	126996	15245	15123
2025027359	6	7,000 lbs.	2.7170"	127012	14276	14125A
2025027345	5	8,000 lbs.	2.6875"	168687	02420	02475
2025027340	5	10,000 lbs.	3.2650"	124287	25520	25580
2025027364	8	12,000 - 16,000 lbs.	3.8437"	293381	28622	28682
Inner						
2025027339	13	2,200 lbs.	1.9800"	125102	L44610	L44649
2025027337	8	3,500 lbs.	2.3612"	124296	L68111	L68149
2025027340	5	5,200 - 8,000 lbs.	3.2650"	124287	25520	25580
2025027357	7	10,000 lbs.	3.8125"	183463	382A	387A
2025027363	5	12,000 - 16,000 lbs.	4.4375"	293379	3920	3984

GREASE SEALS & UNITIZED OIL SEALS

- Provides protective barrier between the axle hub and the outside elements
- Hassle-free grease application
- Double-lip design keeps water out for long-lasting performance
- Durable construction withstands tough conditions and reduces maintenance frequency

Universally compatible with Dexter



2023134654



2023134018

Retail Clamshell #	Sleeve #	Sleeve Qty	Axle Capacity	Spindle Shaft Diameter	Hub Bore Diameter
Grease Seals					
--	2025047575	30	1,250 lbs.	1.250"	1.983"
2023134653	2025047573	30	2,200 lbs.	1.500"	1.983"
2023134654	2025047571	20	3,500 - 4,400 lbs.	1.719"	2.561"
2023134655	2025047572	30	5,200 - 8,000 lbs.	2.250"	3.371"
2023134019	2025027330	10	10,000 lbs.	2.875"	3.875"
2023134020	2025027332	10	12,000 - 16,000 lbs.	3.125"	4.500"
Unitized Oil Seals					
2023134018	2025027331	20	5,200 - 8,000 lbs.	2.250"	3.371"
2023134019	2025027330	10	10,000 lbs.	2.875"	3.875"
2023134020	2025027332	10	12,000 - 16,000 lbs.	3.125"	4.500"

SPINDLE NUT KITS

- Locks wheel bearings in place, preventing unwanted movement and ensuring smooth wheel rotation
- Includes spindle nut, spindle washer, and cotter pin



Retail Clamshell #	Axle Capacity	Thread Size	Includes
2023134656	2,200 - 4,400 lbs.	1"-14	Spindle nut, round washer, and cotter pin
2023134657	2,200 - 4,400 lbs.	1"-14	Spindle nut, D-flat washer, and tang washer
2025027380	5,200 - 8,000 lbs.	1"-14	Spindle nut, D-flat washer, and tang washer
2025027381	5,200 - 8,000 lbs.	1"-14	Spindle nut, round washer, and cotter pin
2023134021	10,000 lbs.	1-1/2" - 12	Spindle nut, round washer, and cotter pin
2023134022	12,000 - 16,000 lbs.	1-3/4" - 12	Spindle nut, round washer, and cotter pin

SPINDLE NUTS

- Locks wheel bearings in place, preventing unwanted movement and ensuring smooth wheel rotation
- Use with a cotter pin or tang washer to lock the nut in place (sold separately)
- Includes 10 spindle nuts per pack



10-Pack #	Axle Capacity	Thread Size
2025027769	3,500 - 8,000 lbs.	1"-14
2025027770	10,000 lbs.	1-1/2" - 12
2025027771	12,000 - 16,000 lbs.	1-3/4" - 12

SPINDLE WASHERS

- Engineered to fit perfectly with your spindle nut and axle assembly, ensuring seamless integration
- Includes one spindle washer



2025027756



2025027757



2025027755



2025027760



2025027754



2025027758



2025027759

10-Pack #	Axle Capacity	Style	Inside Diameter	Outside Diameter
2025027756	2,200 - 4,400 lbs.	Round	1"	1-11/16"
2025027757	2,200 - 4,400 lbs.	D-flat	1"	1-11/16"
2025027755	2,200 - 8,000 lbs.	Locking tang	1"	1-11/16"
2025027760	5,200 - 8,000 lbs.	D-flat	1-1/16"	2"
2025027754	5,200 - 8,000 lbs.	Round	1-1/16"	2"
2025027758	10,000 lbs.	Round	1-1/2"	3"
2025027759	12,000 - 16,000 lbs.	Round	1-7/8"	3-3/8"

COTTER PINS

- Ensures spindle castle nut stays secure
- Cotter pin should be replaced every time the hub is disassembled



2025027790



2025027791

10-Pack #	Axle Capacity	Diameter	Length
2025027790	Up to 8,000 lbs.	1/8"	1-3/4"
2025027791	10,000 - 16,000 lbs.	1/4"	2-1/4"

GREASE ZERK

- Provides the entry point for greasing various suspension components
- Works with all Lippert Super-Lube axle spindles and suspension wet bolts



10-Pack #	For
2025027802	Wet bolt equalizers and lubricated axles



PREMIUM THREADED DUST CAPS

- Keeps dust and debris out, maintaining hub performance
- Magnetic vent plug attracts damaging metal particles
- Helps identify problems before they become critical
- Clear lens allows for visual inspection of oil level (oil caps only)
- Easy-to-access side port lets you fill or drain lubricant without removing the cap (oil caps only)
- Powder-coated aluminum construction provides durability and resistance to corrosion
- Watertight O-ring and rubber plug included for a complete seal
- Easy, threaded installation
- Includes one dust cap per brown box



85373929

85373829

85373928

85373828

Brown Box #	Axle Capacity	Cap Diam. (A)	Lube	Material	Includes
Threaded Grease Caps					
85373929	8,000 lbs.	2-7/8"	Non-lubed	Die-cast aluminum, smoked lens	Rubber plug, O-ring
85373829	10,000 - 16,000 lbs.	4"	Non-lubed	Die-cast aluminum, smoked lens	Rubber plug, O-ring
Threaded Oil Caps					
85373928	8,000 lbs.	2-7/8"	Oil	Die-cast aluminum, clear lens	Rubber plug, O-ring
85373828	10,000 - 16,000 lbs.	4"	Oil	Die-cast aluminum, clear lens	Rubber plug, O-ring

STANDARD PRESS-IN DUST CAPS

- Keeps dust and debris out, maintaining hub performance
- Zinc-plated steel construction
- For use with grease lubricated systems
- Easy, drive-in installation



Shields bearings, grease, and other inner hub components from dust and contaminants

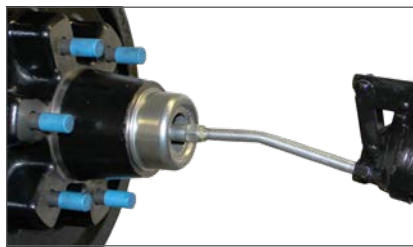

Grease cap with rubber plug allows easy access to grease zerk in axle spindle



Cap diameter

Retail Clamshell #	10-Pack #	Axle Capacity	Cap Diameter (A)	Lube	Material
2023134658	693794	2,200 - 4,400 lbs.	1.99"	Non-lubed	Zinc-plated steel
2023134661*	693824	2,200 - 4,400 lbs.	1.99"	Super lube	Zinc-plated steel
2023134659	693795	5,200 - 6,000 lbs.	2.45"	Non-lubed	Zinc-plated steel
2023134662*	693749	5,200 - 6,000 lbs.	2.45"	Super lube	Zinc-plated steel
2023134660	2023134661	7,000 - 8,000 lbs.	2.72"	Non-lubed	Zinc-plated steel
2023134011*	693748	7,000 - 8,000 lbs.	2.72"	Super lube	Zinc-plated steel

* Includes rubber plugs

RUBBER PLUG FOR PRESS-IN DUST CAPS

- Seals off dust cap from dirt and debris
- For use with standard lubed dust caps
- Dust caps sold separately

Retail Clamshell #	10-Pack #	Axle Capacity	Bore Size
2023134012	693722	2,200 - 8,000 lbs.	Universal





SUSPENSION & SAFETY

PRODUCT INDEX

Scan QR code for most up-to-date products or visit lippert.com



52
Leaf
Springs



53
Leaf Spring
Bushings



54
Road Armor™
Equalizers



55
Equa-Flex®
Equalizers



56
Shock
Assemblies

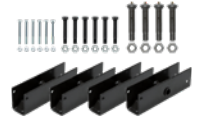

57
Suspension
Kits



62
Equalizers



63
Shackle Links
& Assemblies



65
Hangers



66
U-Bolt
Kits



67
Suspension
Systems



71
ABS & TireLinc®
Auto TPMS



SLIPPER LEAF SPRINGS

Universally compatible with Dexter

- Dampens road shock and vibrations, minimizing strain on the trailer
- Single-eye design allows for more weight capacity and fewer moving parts
- Leaves allow flexibility to absorb road shock, which offers a smoother, more level ride
- Pre-mounted hangers required for installation (hanger kits sold separately)
- Durable steel construction can withstand regular wear and tear
- Bushings are pre-installed into the eye-holes
- Easy, DIY installation
- Ships in durable brown box

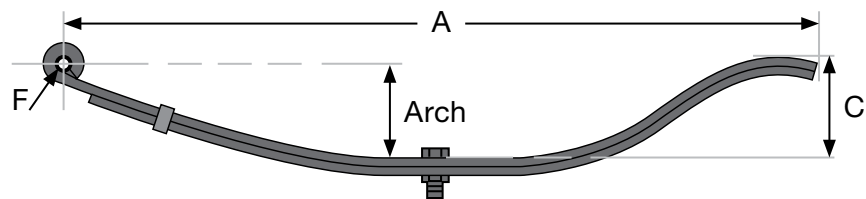

Brown Box #	Spring Capacity	Industry Number*	# of Leaves	Spring Width	Eye-to-End Length (A)	Arch Height Unloaded (C)	Arch Height Loaded (C)	Eye Diam. (F)
132819	1,000 lbs.	72-02	2	1-3/4"	27"	4-3/16"	3-1/8"	9/16"
230281	1,250 lbs.	BT25-12	4	1-3/4"	25"	3-1/2"	2-1/4"	9/16"
157739	1,750 lbs.	BT25-22	3	1-3/4"	25"	3-1/2"	2-1/2"	9/16"
136527	2,000 lbs.	72-30	4	2"	26-7/8"	3"	2"	9/16"
125250	2,500 lbs.	72-31	4	2"	26-7/8"	3-1/16"	2"	9/16"
710493	3,500 lbs.	72-32	5	2"	26-7/8"	3-3/16"	2"	9/16"
342781	3,500 lbs.	E5226	5	2"	26-1/2"	3-1/4"	2-1/2"	9/16"
797547	3,500 lbs.	HW5116	6	2"	26-1/2"	3-1/4"	2"	9/16"
710494	4,000 lbs.	72-33	7	2"	26-7/8"	3-3/16"	2"	9/16"
334744	4,000 lbs.	E5115	6	2"	29-1/2"	3-1/2"	2-1/2"	9/16"
796558	4,000 lbs.	E5226/7	7	2"	26-1/2"	3-1/4"	2"	9/16"
176326	5,000 lbs.	72-80	5	2-1/2"	30-1/2"	4"	2-11/16"	3/4"
296155	6,000 lbs.	72-44	6	3"	30-1/2"	4"	2-3/4"	1"
353498	8,000 lbs.	72-46	6	3"	30-1/2"	4"	2-3/4"	1"
771492	11,200 lbs.	354-00	3	3"	43-3/4"	6-1/4"	5-1/4"	N/A

* Note: Industry number is for reference only. Do not use this number to order your parts

DOUBLE-EYE LEAF SPRINGS

Universally compatible with Dexter

- Dampens road shock and vibrations, minimizing strain on the trailer
- Double-eye design for lightweight trailers
- Leaves allow flexibility to absorb road shock, which offers a smoother, more level ride
- Pre-mounted hangers required for installation (hanger kits sold separately)
- Durable steel construction can withstand regular wear and tear
- Includes nylon bushings (bronze bushings available, sold separately)
- Easy, DIY installation
- Ships in durable brown box

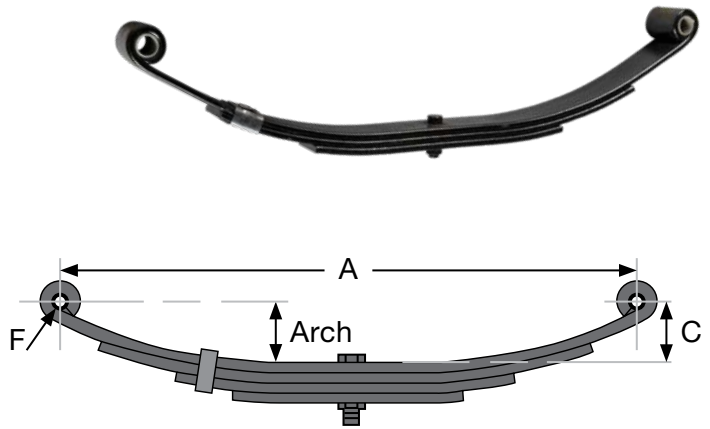

Brown Box #	Spring Capacity	Industry Number*	# of Leaves	Spring Width	Unloaded Eye-to-Eye Length (A)	Loaded Length	Arch Height Unloaded (C)	Arch Height Loaded (C)	Eye Diam. (F)
127094	1,000 lbs.	72-17	3	1-3/4"	20-3/8"	21"	2-7/8"	2-1/8"	9/16"
127103	1,250 lbs.	72-06	3	1-3/4"	23-1/8"	24"	3-1/2"	2-1/2"	9/16"
125215	1,750 lbs.	72-09	3	1-3/4"	23-3/16"	24"	3-1/2"	2-1/2"	9/16"
125799	2,000 lbs.	72-18	3	1-3/4"	23-1/8"	24"	3-1/2"	2-1/2"	9/16"
125797	2,000 lbs.	72-24	3	1-3/4"	25-1/4"	26"	3"	1-3/4"	9/16"
699453	2,000 lbs.	AWS-4	4	1-3/4"	26"	27"	4-1/4"	3"	9/16"
125269	1,400 lbs.	72-13	4	1-3/4"	20-1/2"	21"	3-1/2"	2-3/8"	9/16"
124903	1,750 lbs.	72-42	4	1-3/4"	25-1/4"	26"	3"	1-1/2"	9/16"
702096	3,000 lbs.	72-26	4	1-3/4"	25-1/4"	26"	3-1/8"	1-3/4"	9/16"
129745	2,200 lbs.	72-78	4	1-3/4"	25-1/4"	26"	3-1/8"	2"	9/16"
133982	2,500 lbs.	72-20	4	1-3/4"	23-1/8"	24"	3-1/2"	2-1/2"	9/16"
702095	2,600 lbs.	72-97	4	1-3/4"	25-1/4"	26"	3-1/8"	1-3/4"	9/16"
334743	3,000 lbs.	SW-5	5	1-3/4"	25-1/4"	26"	3-1/8"	1-3/4"	9/16"
679372	3,500 lbs.	72-98	6	1-3/4"	24-7/8"	26"	3-1/4"	1-3/4"	9/16"
2021095282	4,000 lbs.	72-100	7	1-3/4"	24-7/8"	26"	3-1/4"	1-3/4"	9/16"

* Note: Industry number is for reference only. Do not use this number to order your parts

BUSHINGS

- Standard for most Lippert axle hanger attaching part kits
- Compatible with most leaf spring eyes



2025009017



2025009018



2024110549



2024110550

4-Pack Clamshell #	8-Pack Clamshell #	Material	Inside Diameter	Outside Diameter	Length
2025009017	2025009018	Bronze	9/16"	11/16"	1-3/4"
2024110549	2024110550	Nylon	9/16"	11/16"	1-3/4"

ROAD ARMOR™ SHOCK-ABSORBING EQUALIZERS

- Offers superior suspension enhancement with 360° protection
- Provides smoother towing over conventional equalizers
- Helps minimize trailer and cargo damage caused by road shock and vibration
- Two cushioned equalizers replace cast equalizers that came standard on the trailer
- Single pivoting arm absorbs and dampens road shock from the leading or trailing spring
- Sturdy steel construction with UV and corrosion-resistant, black powder coat finish
- DIY, bolt-on installation — no drilling or welding required
- Zinc-plated fasteners offer corrosion resistance
- Suspension mounting kits sold separately



2024115697

2024115689



2024115710

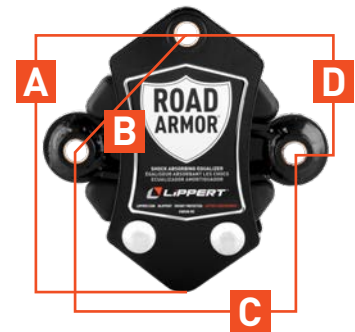

Engineered to obtain maximum absorption with anti-shock technology



Pre-installed bronze bushings improve wear and tear



Retail Box #	Axle Capacity	Axle Configuration	A	B	C	D	E
2024115689	3,500 - 8,000 lbs.	Tandem	7-1/4"	4-3/8"	6"	3-1/4"	--
2024115697	3,500 - 8,000 lbs.	Triple, short	7-1/4"	4-3/8"	6"	3-1/4"	6-3/4"
2024115710	3,500 - 8,000 lbs.	Triple, long	7-1/4"	4-3/8"	6"	3-1/4"	7-5/8"

EQUA-FLEX® RUBBERIZED EQUALIZERS

- Reduces fore-and-aft trailer movement, otherwise known as chucking
- Dual-pivoting arms absorb and dampen road shock from the leading or trailing spring
- Provides smoother towing over conventional equalizers
- Cushioned equalizers replace cast equalizers that came standard on your trailer
- Sturdy steel construction with UV and corrosion-resistant, black powder coat finish
- DIY, bolt-on installation — no drilling or welding required
- Zinc-plated fasteners for corrosion resistance
- Suspension mounting kits sold separately



2024114953



2024115101



2024115051



2024115382

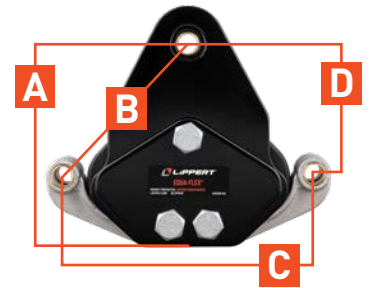

Helps minimize trailer and cargo damage caused by road shock and vibration



Pre-installed bronze bushings improve wear and tear



Retail Box #	Axle Capacity	Axle Configuration	A	B	C	D	E
2024114953	4,000 - 6,000 lbs.	Tandem	6"	4-1/8"	5-1/2"	2-7/8"	--
2024115051	6,000 - 8,000 lbs.	Tandem	7-1/4"	5-1/2"	7-1/4"	3-5/8"	--
2024115101	5,000 - 8,000 lbs.	Triple, short	7-1/4"	5-1/2"	7-1/4"	3-5/8"	7-1/2"
2024115382	5,000 - 8,000-lbs.	Triple, long	7-1/4"	5-1/2"	7-1/4"	3-5/8"	8-3/8"



SHOCK ASSEMBLIES

- Bolt-on shock kit absorbs road shock to provide a more comfortable towing experience
- Kit comes with everything needed to attach gas shocks to an existing trailer suspension
- Single replacement shocks are also available



281281



281255



283280



283271

Part #	Includes	Fits	Compressed Length	Extended Length
281255	Two shock assemblies, four U-bolts, two shock mount assemblies, two tie plates, eight washers, hex nuts, and hex bolts	2-3/8" axles tubes	8-5/8"	13-1/2"
281281	Two shock assemblies, four U-bolts, two shock mount assemblies, two tie plates, eight washers, hex nuts, and hex bolts	3" axles tubes	8-5/8"	13-1/2"
283280	One heavy-duty yellow shock, four top plates, four rubber bushings, two nuts	All axle tube sizes	8-5/8"	13-1/2"
283271	One standard black shock, four top plates, four rubber bushings, two nuts	All axle tube sizes	7-1/2"	12"

SLIPPER SUSPENSION KITS

All kit component SKUs
are for reference only

- Complete kit includes equalizers and attaching hardware to mount your axle to the chassis

Tandem Axle Kit - #128877

- Compatible with 3,500 to 8,000-lb. axles
- Use with 2" wide slipper springs
- Axle spacing: 33-1/2"
- Industry standard #: EQ-13-4



Part #	Description	Qty
127771	Equalizer	2
126782	Bolt - 9/16"-18 x 3-1/2"	2
127846	Bolt - 7/8"-9 x 4-5/8"	2
127828	Bolt - 5/16"-18 x 3-1/4"	4
125801	Nut - 9/16"-18	2
127802	Nut - 7/8"-9	2
127799	Nut - 5/16"-18	4

Tandem Axle Kit - #165268

- Compatible with 3,500 to 8,000-lb. axles
- Use with 2" wide slipper springs
- Axle spacing: 36"
- Industry standard #: EQ-13-44

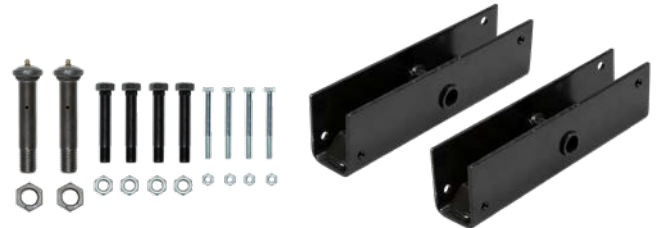

Part #	Description	Qty
165270	Equalizer	2
126782	Bolt - 9/16"-18 x 3-1/2"	4
127846	Bolt - 7/8"-9 x 4-5/8"	2
127828	Bolt - 5/16"-18 x 3-1/4"	4
125801	Nut - 9/16"-18	4
127802	Nut - 7/8"-9	2
127799	Nut - 5/16"-18	4

Tandem Axle Kit - #184173

- Compatible with 10,000-lb. axles
- Use with 2-1/2" wide slipper springs
- Axle spacing: 42-1/4"



Part #	Description	Qty
182257	Equalizer	2
184138	Bolt - 1" - 8 x 6"	2
184137	Bolt - 3/4"-10 x 4-1/2"	2
178715	Nut - 1"-8	2
119094	Nut - 3/4" - 10	4

Tandem Axle Kit - #184175

- Compatible with 10,000-lb. axles
- Use with 2-1/2" wide slipper springs
- Axle spacing: 48-1/2"

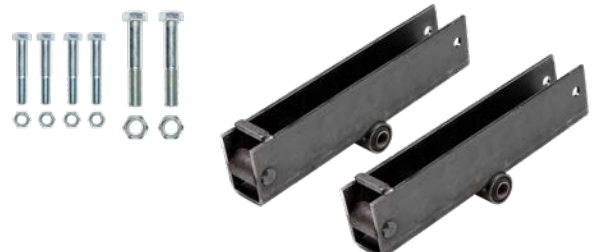

Part #	Description	Qty
182269	Equalizer	6
184138	Bolt - 1"-8 x 6"	2
184137	Bolt - 3/4"-10 x 4-1/2"	4
178715	Nut - 1"-8	2
119094	Nut - 3/4"-10	4

SLIPPER SUSPENSION KITS

All kit component SKUs are for reference only

- Complete kit includes equalizers and attaching hardware to mount your axle to the chassis

Tandem Axle Kit - #302934

- Compatible with 12,000 - 16,000-lb. axles
- Use with 3" wide slipper springs
- Axle spacing: 42-1/4"



Part #	Description	Qty
299015	Equalizer	2
301404	Bolt - 1-1/8"-7 x 6"	2
301405	Bolt - 1"-8 x 5-1/2"	4
301406	Bolt - 1/2"-20 x 4-1/2"	4
301408	Nut - 1-1/8"-7	2
301409	Nut - 1"-8	4
301410	Hex flange nut - 7/16"-20	4

Tandem Axle Kit - #302964

- Compatible with 12,000 - 16,000-lb. axles
- Use with 3" wide slipper springs
- Axle spacing: 48-1/2"



Part #	Description	Qty
299017	Equalizer	2
301404	Bolt - 1-1/8"-7 x 6"	2
301405	Bolt - 1"-8 x 5-1/2"	4
301406	Bolt - 1/2"-20 x 4-1/2"	4
301408	Nut - 1-1/8"-7	2
301409	Nut - 1"-8	4
301410	Hex flange nut - 7/16"-20	4

Triple Axle Kit - #137383

- Compatible with 3,500 to 8,000-lb. axles
- Use with 2" wide slipper springs
- Axle spacing: 33-1/2"
- Industry standard #: EQ-13-4

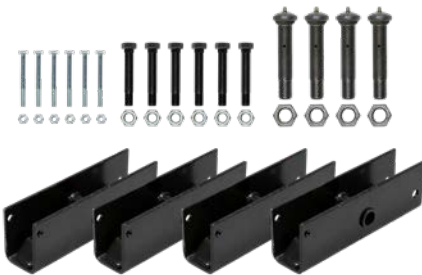

Part #	Description	Qty
127771	Equalizer	4
126782	Bolt - 9/16"-8 x 3-1/2"	6
127846	Bolt - 7/8"-9 x 4-11/16"	4
127828	Bolt - 5/16"-18 x 3-1/4"	6
125801	Nut - 9/16"-18	6
127802	Nut - 7/8"-9	4
127799	Nut - 5/16"-18	6

Triple Axle Kit - #169381

- Compatible with 3,500 to 8,000-lb. axles
- Use with 2" wide slipper springs
- Axle spacing: 36"
- Industry standard #: EQ-13-44

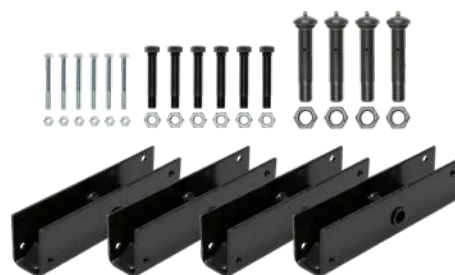

Part #	Description	Qty
165270	Equalizer	4
126782	Bolt - 9/16"-18 x 3-1/2"	6
127846	Bolt - 7/8" 9 x 4-5/8"	4
127828	Bolt - 5/16"-18 x 3-1/4"	6
125801	Nut - 9/16"-18	6
127802	Nut - 7/8"-9	4
127799	Nut - 5/16"-18	6

SLIPPER SUSPENSION KITS

All kit component SKUs
are for reference only

- Complete kit includes equalizers and attaching hardware to mount your axle to the chassis

Triple Axle Kit - #184174

- Compatible with 10,000-lb. axles
- Use with 2-1/2" wide slipper springs
- Axle spacing: 42-1/4"

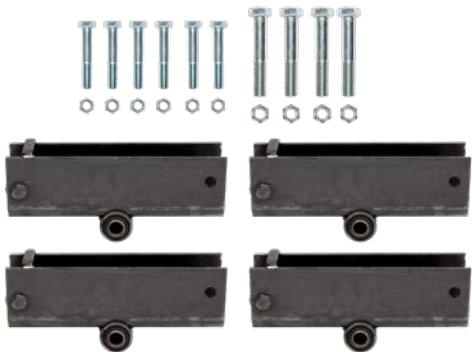

Part #	Description	Qty
182257	Equalizer	4
184138	Bolt - 1" - 8 x 6"	4
184137	Bolt - 3/4"-10 x 4-1/2"	6
178715	Nut - 1"-8	4
119094	Nut - 3/4" - 10	6

Triple Axle Kit - #184176

- Compatible with 10,000-lb. axles
- Use with 2-1/2" wide slipper springs
- Axle spacing: 48-1/2"

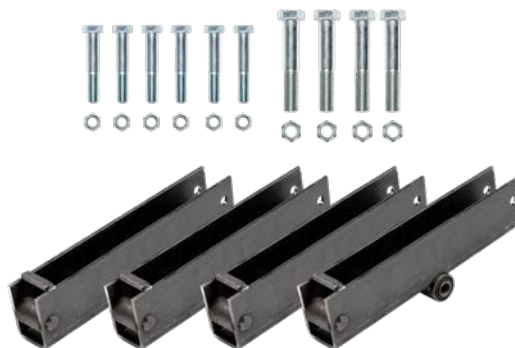

Part #	Description	Qty
182269	Equalizer	4
184138	Bolt - 1"-8 x 6"	4
184137	Bolt - 3/4"-10 x 4-1/2"	6
178715	Nut - 1"-8	4
119094	Nut - 3/4"-10	6

Triple Axle Kit - #321435

- Compatible with 12,000 - 16,000-lb. axles
- Use with 3" wide slipper springs
- Axle spacing: 42-1/4"

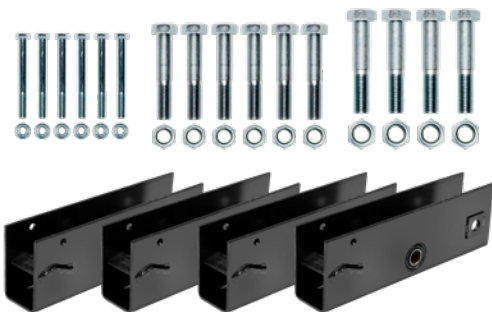

Part #	Description	Qty
299015	Equalizer	4
301404	Bolt - 1-1/8"-7 x 6"	4
301405	Bolt - 1"-8 x 5-1/2"	6
301406	Bolt - 1/2"-20 x 4-1/2"	6
301408	Nut - 1-1/8"-7	4
301409	Nut - 1"-8	6
301410	Hex flange nut - 7/16"-20	6

Triple Axle Kit- #321436

- Compatible with 12,000 - 16,000-lb. axles
- Use with 3" wide slipper springs
- Axle spacing: 48-1/2"

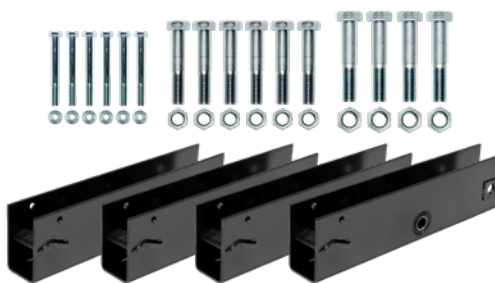

Part #	Description	Qty
299017	Equalizer	4
301404	Bolt - 1-1/8"-7 x 6"	4
301405	Bolt - 1"-8 x 5-1/2"	6
301406	Bolt - 1/2"-20 x 4-1/2"	6
301408	Nut - 1-1/8"-7	4
301409	Nut - 1"-8	6
301410	Hex flange nut - 7/16"-20	6

DOUBLE-EYE SUSPENSION KITS

All kit component SKUs are for reference only

- Complete kit includes equalizers and attaching hardware to mount your axle to the chassis

Single Axle Kit - #121101

- Compatible with 2,200 - 8,000-lb. axles
- Use with 1-3/4" wide double-eye springs



Part #	Description	Qty
133485	Shackle assembly	2
122102	Shoulder bolt - 9/16" x 2-5/16"	2
133207	Shackle link - 3-1/8"	2
122103	Nut - 7/16"-20	6

Tandem Axle Kit - #121097

- Compatible with 2,200 - 8,000-lb. axles
- Use with 1-3/4" wide double-eye springs
- Axle spacing: 33"
- Industry standard #: EQ-104

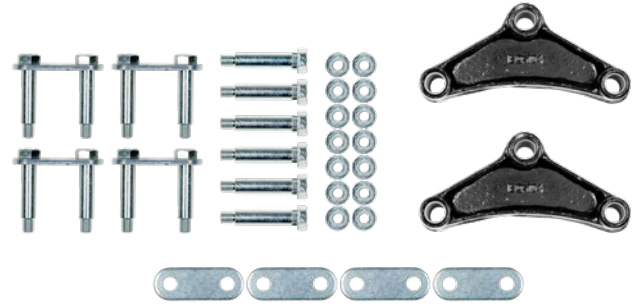

Part #	Description	Qty
126460	Equalizer assembly	2
125675	Shackle link assembly	4
122102	Bolt - .438 - 20 x 2-7/8"	6
122487	Shackle link - 2-1/4"	4
122103	Nut - 7/16 - 20	14

Tandem Axle Kit- #121098

- Compatible with 2,200 - 8,000-lb. axles
- Use with 1-3/4" wide double-eye springs
- Axle spacing: 33"
- Industry standard #: EQ-310

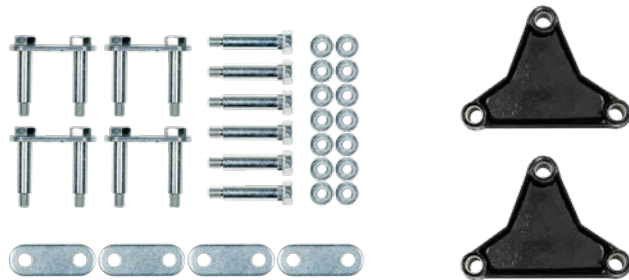

Part #	Description	Qty
126741	Equalizer assembly	2
125675	Shackle link assembly - 2-1/4"	4
122487	Shackle link - 2-1/4"	4
122102	Shoulder bolt - 9/16" x 2-5/16"	6
122103	Flange nut - 7/16"-20	14

Tandem Axle Kit - #156767

- Compatible with 2,200 - 8,000-lb. axles
- Use with 1-3/4" wide double-eye springs
- Axle spacing: 33" or 35"



Part #	Description	Qty
156766	Shackle link assembly	4
126238	Bolt - 9/16" x 2-5/16"	6
716205	Shackle links	4
122103	Hex flange nut - 7/16"-20	14

DOUBLE-EYE SUSPENSION KITS

All kit component SKUs
are for reference only

- Complete kit includes equalizers and attaching hardware to mount your axle to the chassis

Tandem Kit - #121099

- Compatible with 2,200 - 8,000-lb. axles
- Use with 1-3/4" wide double-eye springs
- Axle spacing: 35"
- Industry standard #: EQ-E1



Part #	Description	Qty
122106	Equalizer assembly	2
125675	Shackle link assembly - 2-1/4"	4
122102	Shoulder bolt - 9/16" x 2-5/16"	6
122487	Shackle link - 2-1/4"	4
122103	Hex flange nut - 7/16"-20	14

Triple Kit - #121100

- Compatible with 2,200 - 8,000-lb. axles
- Use with 1-3/4" wide double-eye springs
- Axle spacing: 33"
- Industry standard #: EQ-104 & 105

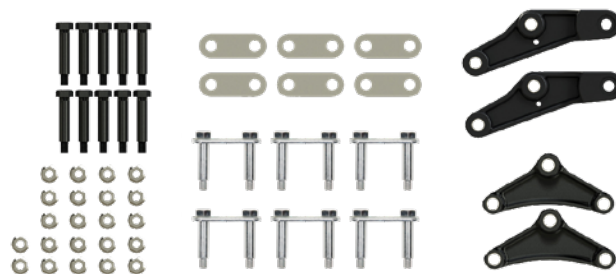

Part #	Description	Qty
126277	Equalizer	2
126460	Equalizer assembly	2
125675	Shackle link assembly	6
122102	Shoulder bolt - 9/16" x 2-5/16"	10
122487	Shackle link - 2-1/4"	6
122103	Hex flange nut - 7/16"-20	22

Triple Kit - #132698

- Compatible with 2,200 - 8,000-lb. axles
- Use with 1-3/4" wide double-eye springs
- Axle spacing: 35"
- Industry standard #: EQ-1 & 13-126

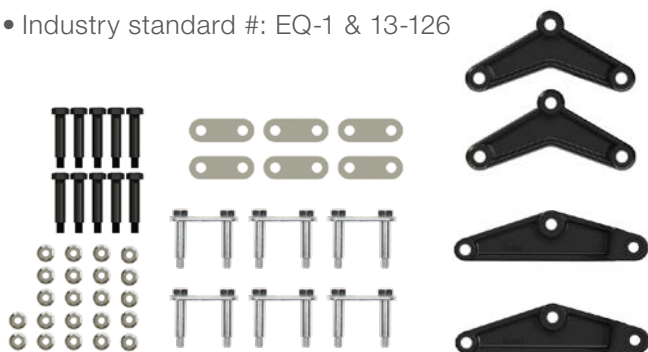

Part #	Description	Qty
122106	Equalizer assembly	2
181823	Equalizer	2
125675	Shackle link assembly - 2-1/4"	6
122102	Shoulder bolt - 9/16" x 2-5/16"	10
122487	Shackle link - 2-1/4"	6
122103	Hex flange nut - 7/16"-20	22

EQUALIZERS

- Connects the springs on tandem or triple-axle trailers
- Transfers load and impact from one axle to another by permitting movement between the axles
- Pre-installed bushings maintain a well-functioning system and ensure proper sizing for suspension bolts
- Includes one equalizer in a durable brown box

How to measure different equalizer styles

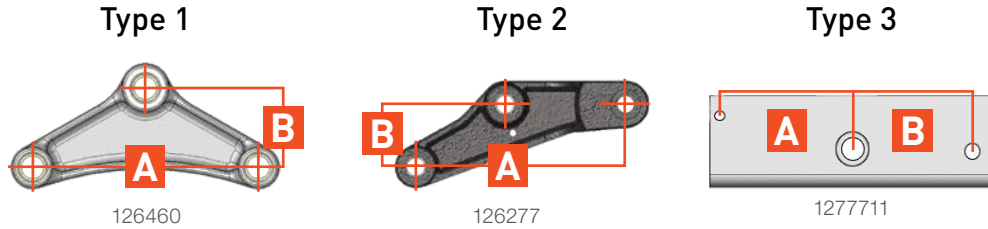

Slipper leaf spring equalizers



Brown Box #	Industry Number*	Number of Axles	Spring Width	Axle Spacing	Type	A (Width)	B (Height)
1277711	EQ-1304	2 / 3	2"	33-1/2"	3	5-1/8"	4-5/8"
182257	--	2 / 3	2-1/2"	42-1/4"	3	6-7/8"	6-11/16"
182269	--	2 / 3	2-1/2"	48-1/2"	3	9-9/16"	9-9/16"
299015	--	2 / 3	3"	42-1/4"	3	7"	7-1/8"
299017	--	2 / 3	3"	48-1/2"	3	10-3/4"	10-1/4"

* Note: Industry number is for reference only. Do not use this number to order your parts

Double-eye leaf spring equalizers



Brown Box #	Industry Number*	Number of Axles	Spring Width	Axle Spacing	Type	A (Width)	B (Height)
126460	EQ-104	2	1-3/4"	33"	1	5-3/4"	2"
122106	EQ-E1	2	1-3/4"	35"	1	7-3/4"	2-7/8"
126741	EQ-310	2	1-3/4"	33"	1	6-1/16"	4"
126277	EQ-105	3	1-3/4"	33"	2	6-3/4"	2"
181823	EQ-126	3	1-3/4"	35"	2	8-11/16"	2-1/2"

* Note: Industry number is for reference only. Do not use this number to order your parts

SHACKLE LINK ASSEMBLIES

- Connects suspension springs and axle hangers
- Typically used with greaseable wet bolts
- Zinc-plated construction



125675



133485

Part #	Shackle Thickness	Center-to-Center	Suggested Nut #
125675	0.224"	2-1/4"	122103
133485	0.224"	3-1/8"	122103
126205	1/2"	2-1/4"	122103
156766	1/2"	3-1/8"	122103

SHACKLE LINKS

- Designed for 1-3/4" wide double-eye spring suspension kits
- Connects suspension springs to the rear hanger or equalizer on your trailer
- Typically used with greaseable wet bolts
- Zinc-plated construction for corrosion resistance



2024120104



2024120105



2024120108



2024120109

Retail Clamshell 4-Pack #	10-Pack #	Shackle Thickness	Center-to-Center
2024120104	2025027382	0.224"	2-1/4"
2024120105	2025027383	0.224"	3-1/8"
2024120108	2025027384	1/2"	2-1/4"
2024120109	2025027385	1/2"	3-1/8"

SUSPENSION BOLTS

- Designed for 1-3/4" wide double-eye spring suspension kits
- Connects suspension springs and axle hangers in conjunction with shackle links
- Grease zerk allows for easy lubrication to keep moving parts functioning properly (select SKUs)
- Zinc-plated construction for corrosion resistance



2024120106



2024120107



2024120110

Retail 4-pack #	10-Pack #	Type	Diameter	Shoulder Length	Thread size	Suggested Nut
--	2025047556	Hex bolt	5/16"	3-1/4"	5/16"-18	2025047554
--	2025047565	Hex bolt	1/2"	4-1/2"	1/2"-20	2025047566
2024120106	2025027751	Shoulder bolt	9/16"	2-5/16"	7/16"-20	2025027783
2025047366	2025027731	Shoulder bolt	9/16"	2-13/16"	7/16"-20	2025027783
2024120107	2025027733	Wet bolt	9/16"	2-5/16"	7/16"-20	2025027783
2024120110	2025027732	Wet bolt	9/16"	2-13/16"	7/16"-20	2025027783
--	2025047553	Hex bolt	9/16"	3-1/2"	9/16"-18	2025047552
--	2025047559	Hex bolt	3/4"	4-1/2"	3/4"-10	2025047551
--	2025047557	Wet bolt	7/8"	4-3/4"	7/8"-9	2025047555
--	2025047560	Hex bolt	1"	6"	1"-8	2025047558
--	2025047564	Hex bolt	1"	5-1/2"	1"-8	2025027796
--	2025047563	Hex bolt	1-1/8"	6"	1-1/8"-7	2025027801

SUSPENSION NUTS



2025027783

10-Pack #	Type	Thread size
2025047554	Hex nut	5/16"-18
2025027783	Hex flange nut	7/16"-20
2025047566	Hex flange nut	1/2"-20
2025047552	Hex nut	9/16"-18
2025047551	Hex lock nut	3/4"-10
2025047555	Hex lock nut	7/8"-9
2025047558	Hex lock nut	1"-8
2025027796	Hex nut	1"-8
2025027801	Hex nut	1-1/8"-7

HANGERS

- Welded to the chassis to allow the mounting of axles and axle components
- Constructed from 1/4" thick steel for a reliable connection

Slipper leaf spring hangers



Part #	Axle Capacity	Location	To Hole (A)	Length (B)	Width (C)	Hole Size (D)
127784	2,200 - 8,000 lbs.	Front	3-9/16"	4-5/16"	2-3/16"	9/16"
127783	2,200 - 8,000 lbs.	Rear	4"	6"	2-1/4"	5/16"
127782	2,200 - 8,000 lbs.	Center	3-5/16"	4-1/2"	3-1/8"	7/8"
182242	10,000 lbs.	Front	5-1/2"	8"	2-3/4"	3/4"
182245	10,000 lbs.	Rear	6-1/8"	8"	2-3/4"	--
184079	10,000 lbs.	Center	1-7/8"	3-1/4"	4-1/8"	1"
298462	12,000 - 16,000 lbs.	Front	6-1/4"	7-1/2"	3-1/8"	1"
298458	12,000 - 16,000 lbs.	Center	4-1/8"	5-5/8"	3-7/8"	1-1/8"
298553	12,000 - 16,000 lbs.	Rear	6-5/8"	8-1/2"	3-1/8"	1/2"

Double-eye leaf spring hangers



Part #	Axle Capacity	To Hole (A)	Length (B)	Width (C)	Hole Size (D)
106181	2,200 - 8,000 lbs.	1-1/4"	1-15/16"	2"	9/16"
106182	2,200 - 8,000 lbs.	2-1/4"	2-15/16"	2"	9/16"
106183	2,200 - 8,000 lbs.	3-1/4"	3-1/16"	2"	9/16"
106185	2,200 - 8,000 lbs.	4-1/4"	4-15/16"	2"	9/16"
106184	2,200 - 8,000 lbs.	5"	5-5/8"	2"	9/16"
102906	2,200 - 8,000 lbs.	3" (A) / 5" (A1)	5"	2"	9/16"

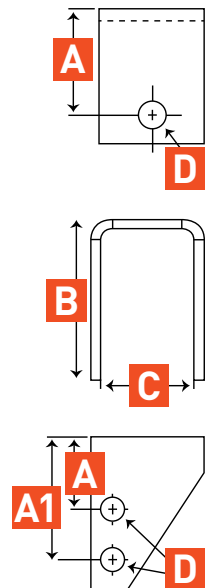

U-BOLT MOUNTING KITS

- Zinc-plated U-bolts and nuts with black powder-coated tie plates
- Durable steel construction for long-lasting performance
- Features fine threads for superior holding strength
- Includes four U-bolts, two tie-plates, and eight nuts



297426



297427



297429



2024118832

Part #	Axle Capacity	Fits Axle Tube Size	Length	Thread Size	Slipper Spring Width	Double-Eye Spring Width
297426	2,200 lbs.	1-3/4"	4-3/8"	3/8"-24	2"	1-3/4"
297427	3,500 lbs.	2-3/8"	5-1/8"	1/2"-20	2"	1-3/4"
297429	4,400 lbs.	3"	6-1/2"	1/2"-20	2"	1-3/4"
2024118832	8,000 lbs.	3"	7-1/4"	9/16"-18	2"	1-3/4"

U-BOLT & NUT KITS

- Zinc-plated finish on U-bolts resists rust and corrosion
- Durable steel construction for long-lasting performance
- Features fine threads for superior holding strength
- Includes two U-bolts and four nuts



2024117444

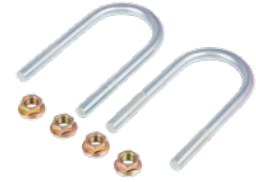

2024117446



2024117447



2024117449



2024117450



2024117451

Retail #	Axle Capacity	Fits Axle Tube Size	Length	Thread Size
2024117444	2,200 lbs.	1-3/4"	4-3/8"	3/8"-24
2024117446	3,500 lbs.	2-3/8"	5-1/8"	1/2"-20
2024117447	4,400 lbs.	3"	6-1/2"	1/2"-20
2024117449	8,000 lbs.	3"	7-1/4"	9/16"-18
2024117450	10,000 lbs.	4"	8-3/4"	5/8"-11
2024117451	10,000 - 16,000 lbs.	5"	10"	5/8"-11



SLIPPER ROLLER SUSPENSION

- Maintenance-free slipper spring suspension technology eliminates component wear
- Axles remain parallel while negotiating uneven roads and side-to-side weight differences
- Reduced bump steer and tire wear
- Improved fuel efficiency
- Reduced operating noise
- Quick installation due to reduced bolted joints and no shackle link or hanger bolt assembly
- 2" wide slipper spring reduces stress on the system by 15 to 20% for improved durability and safety
- Available in a wider stance to improve towing stability
- Self-adjusting brakes for improved stopping ability and reduced maintenance
- Includes black powder-coated springs, axle tube, and tie-plates, along with dichromate hardware for superior corrosion resistance
- Valcrum universal aluminum hub caps are available for 6K, 7K, and 8K axles capacities only

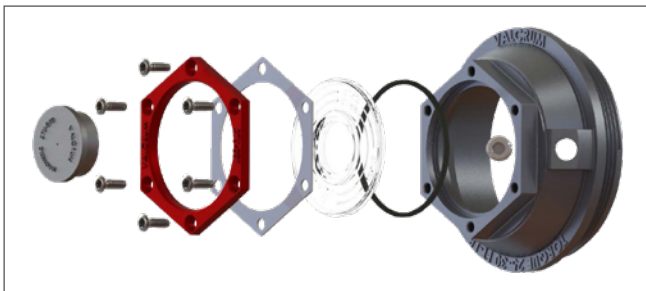

Valcrum universal aluminum hub caps offer a superior upgrade over their plastic counterparts. The aluminum alloy provides better heat dissipation and thermal management. Each cap also features a fill / drain grease port, a magnetic vent plug, and machined threads



Rubber bushed spring eyes and equalizer to protect unit from vibration, also eliminates all maintenance and wear

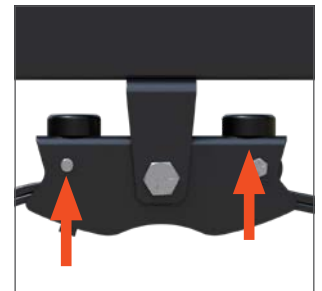

Bump stops on equalizer to prevent over-rotation and high impact loads to frame

INDEPENDENT SUSPENSION ADVENTURE EDITION

- Independent, adaptive suspension with cushioned, road dampening technology
- Increased suspension travel elicits a reduced spring rate compared to other suspensions resulting in a smoother ride
- Axle-free design provides greater ground clearance for any terrain
- Additional clearance between suspension and tires
- Self-adjusting electric drum brakes minimize servicing
- Practical suspension design with a sub-frame that mounts to the chassis with six attaching fasteners
- Durable powder coat finish for enhanced corrosion resistance
- Toe and camber adjustment system for tire alignment and precise adjustment
- Elegant design for an enhanced aesthetic appeal
- Available in 3,500, 4,870, and 5,200-lb. capacities and straight or 4" drop spindle options
- Available in single and tandem configurations and with anti-lock brake system technology

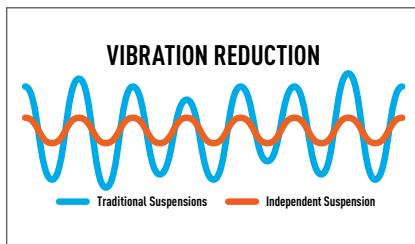

Suspension system reduces rattling and vibration for a more comfortable ride



Gas shocks dampen spring oscillations for improved ride quality and vehicle handling



Coil spring with bump stops to prevent harsh 'bottoming out'

Available in single or tandem configurations





INDEPENDENT SUSPENSION TOURING EDITION

- Proprietary dampening and road isolation technology protects your investment from road shock and vibration
- Suspension system reduces rattling and vibration for a more comfortable ride
- Provides nearly two times more articulation compared to a leaf spring suspension
- Ideal suspension to combat everyday potholes, rough highways, and roads
- Improved design extends longevity compared to leaf springs
- Track bar design stabilizes the axles and suspension and reduces chassis movement during extreme turn situations
- Durable powder coat finish for enhanced corrosion resistance
- Weight capacities up to 5,200 lbs. (Touring) and 8,000 lbs. (Touring HD) per axle
- Available in single and tandem configurations and with anti-lock brake system technology

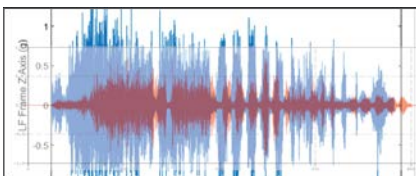

- Touring Coil Suspension
- Traditional Leaf Spring

Suspension system reduces rattling and vibration for a more comfortable ride



Robustly designed with 50% fewer fasteners means reduced need for service



Trailing arm style suspension with coil springs and shock absorbers



With anti-lock braking system



Without anti-lock braking system

ANTI-LOCK BRAKING SYSTEM

- Promotes exceptional towing safety and driver confidence
- Improves control on slippery roads and in emergency braking situations
- Integrates with trailer brakes to prevent trailer wheel lock-up
- Ready to connect to the OneControl® app and Compass Connect
- App provides digital odometer, system monitoring, and more
- Works with electromagnetic drum brakes (7-way wiring connector required)
- Fully compatible with or without OEM or aftermarket brake controllers
- Non-intrusive system will not interfere with trailer gain settings



2021017577

Part #	Wheels	Axles	Includes
2021017577	2 to 6	1 to 3	Anti-lock brake system and all required wiring harnesses for installation



TIRE LINC® AUTO TRAILER TEMPERATURE & PRESSURE MONITORING SYSTEM

- Actively monitors tire pressure and temperature in real-time
- Provides push notifications when hazardous conditions occur to prevent blowouts
- Connects wirelessly through your smartphone via Bluetooth® connection
- Includes rechargeable lithium-powered battery for up to 60 hours of active use
- Automatically enters low-power mode when not in motion to preserve battery
- Easy, do-it-yourself installation (can be permanently wired with provided splice-in wiring harness)
- IP67-rated construction is dustproof and waterproof up to one meter
- Portable design allows use with multiple trailers
- Sensors come with replaceable CR1632 batteries

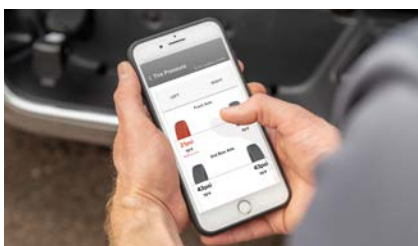

Tire Linc technology integrates with the CURT OneControl® app and provides real-time notifications to your smartphone



Monitors up to 20 tires simultaneously, making it the ideal solution for travel trailers, boat trailers, and agricultural or utility trailers



Advanced repeater technology ensures your smartphone always has current information with a strong connection while on the road

Retail Box #	Description	Wheels	Includes
57009	Tire Linc kit	Up to 4	Repeater, four sensors, installation hardware
57011	Tire Linc sensors	Adds 2	Two sensors



TECHNICAL INSTITUTE TRAINING



Learn with us

With the Lippert Technical Institute, it's easy to get the training you and your employees need to successfully sell Lippert products. Contact us today to sign up for in-person or online courses!

WHO WE TRAIN

Technicians

- Gain a better understanding of how components come together and their functions
- Receive information on new products or updates on existing products
- Get hands-on experience on mock-ups that we build in house

Sales

- Learn the features and benefits of Lippert products
- Become familiarized with Lippert Now app for smart phones and how to use it to your advantage

Parts

- Learn about Lippert resources for parts identification
- Gain information on effective ways to communicate with technicians regarding replacement part kits
- Discover the advantages of using the Lippert Dealer Portal

Warranty

- Learn about claims processing and processes Lippert NOW app and website
- Receive training on how to operate the interactive flat rate chart

TYPES OF TRAINING

Lippert technician service schools

- Three-day event covering multiple components
- Classes are completed with PowerPoint, hands-on instruction and troubleshooting
- Other suppliers offer classes at our schools
- This is our most extensive training and is hosted at our Lippert Technical Institute in Mishawaka, IN
- All technicians are welcome
- Limited space available, be sure to register

Lippert regional training seminars

- One-day to three-day events covering multiple components
- These courses are seminar based and will have parts and pieces for demonstration
- Not full hands-on training as with our technician service schools
- Offered throughout the country multiple times a year

Online webinars

- New courses released to our library monthly
- Create an account at lippert.learnupon.com
- Courses can be accessed at any time
- Complete immediately or leave and come back at your convenience

SCHEDULE YOUR TRAINING

View our current schedule at support.lci1.com/technician-training
Email us at LCItraining@lci1.com



WHENEVER, WHEREVER,
WE MAKE YOUR EXPERIENCE BETTER.™

Connect With Us

Lippert | 432.LIPPERT | lippert.com

CURT | 877.287.8634 | curtmfg.com

All product names, logos, brands and other trademarks shown are the property of their respective trademark holders, and use of them does not imply any affiliation with or endorsement by them.